



SACRAMENTO CITY UNIFIED SCHOOL DISTRICT BOARD OF EDUCATION

Agenda Item# 11.1c

Meeting Date: August 1, 2019

Subject: Approve Resolution No. 3091 - The Sacramento City Unified School District Community Facilities District No. 2 Tax Report for Fiscal Year 2019 – 2020 and Levying and Apportioning the Special Tax as Provided Therein

- Information Item Only
- Approval on Consent Agenda
- Conference (for discussion only)
- Conference/First Reading (Action Anticipated: _____)
- Conference/Action
- Action
- Public Hearing

Division: Facilities Support Services

Recommendation: Approve Resolution No. 3091 - Sacramento City Unified School District Community Facilities District No. 2 Tax Report for Fiscal Year 2019 – 2020 and Levying and Apportioning the Special Tax.

Background/Rationale: On January 27, 1992, the Sacramento City Unified School District, Board of Education, adopted Resolution 1588 establishing Sacramento City Unified School District Community Facilities District (CFD) No. 2 for the purpose of providing for the financing of certain facilities in and for CFD No. 2 and providing for the levy of a special tax in and for CFD No. 2.

Pursuant to Section 53340 of the Government Code of the State of California, the special tax is levied at the rates specified in the Tax Report and shall be collected by the Tax Collector of the County of Sacramento in the same manner as ordinary ad valorem property taxes are collected and shall be subject to the same procedure, sale, and lien priorities in case of delinquency as is provided for ad valorem taxes, subject to all other conditions set forth in the Ordinance.

Copies of the CFD #2 Special Tax Report are available for public review at the reception counter or the Board of Education office.

Financial Considerations: Additional restricted revenue to the District (\$1,813,713.09).

LCAP Goal(s): Safe, Clean and Healthy Schools

Documents Attached:

1. Resolution No. 3091
2. CFD No. 2 Special Tax Report

Estimated Time of Presentation: N/A

Submitted by: Cathy Allen, Chief Operations Officer

Approved by: Jorge A. Aguilar, Superintendent

**SACRAMENTO CITY UNIFIED SCHOOL DISTRICT
BOARD OF EDUCATION**

RESOLUTION NO.3091

**A RESOLUTION APPROVING THE SACRAMENTO CITY
UNIFIED SCHOOL DISTRICT COMMUNITY FACILITIES
DISTRICT NO. 2 TAX REPORT FOR FISCAL YEAR 2019-20
AND LEVYING AND APPORTIONING THE SPECIAL TAX
AS PROVIDED THEREIN**

**SACRAMENTO CITY UNIFIED SCHOOL DISTRICT
COMMUNITY FACILITIES DISTRICT NO. 2**

WHEREAS, the Governing Board of the Sacramento City Unified School District (the "Board") on January 27, 1992 duly adopted Resolution No. 1588 (the "Resolution") establishing Sacramento City Unified School District Community Facilities District No. 2 (the "Community Facilities District," or "CFD No. 2") for the purpose of providing for the financing of certain facilities in and for CFD No. 2 and providing for the levy of a special tax in and for CFD No. 2.

WHEREAS, the Sacramento City Unified School District Community Facilities District No. 2 Tax Report, Fiscal Year 2019-20 (the "Tax Report") has been submitted to the Board and the Board has determined to approve the Tax Report to levy the special tax at the rates specified in the Tax Report and to apportion them in the manner specified therein.

NOW, THEREFORE, the Board, acting on behalf of CFD No. 2, resolves as follows:

Section 1. The Sacramento City Unified School District CFD No. 2 Tax Report, Fiscal Year 2019-20, in the form submitted to this meeting and on file with the Board is hereby approved and adopted.

Section 2. Pursuant to section 53340 of the Government Code of the State of California, the special tax is hereby levied at the rates specified in the Tax Report and is hereby apportioned in the manner specified in the Resolution (and as more particularly described in the Tax Report).

Section 3. Pursuant to section 53340 of the Government Code of the State of California, the special tax shall be collected by the Tax Collector of the County of Sacramento in the same manner as ordinary ad valorem property taxes are collected and shall be subject to the same procedure, sale, and lien priorities in case of delinquency as is provided for ad valorem taxes, subject to all other conditions set forth in the Resolution.

Section 4. In order to have the tax levied hereby collected in the next tax collection period and thus available to finance the facilities approved by the electors of CFD No. 2, the Superintendent shall deliver the Tax Report together with a certified copy of this Resolution to the tax collector of the County of Sacramento no later than August 10, 2019.

Section 5. The Superintendent and his designees are hereby authorized to make changes to the Tax Report in response to appeals from taxpayers or otherwise in order to correct errors that may, from time to time, arise in the application of the special tax to particular parcels. Claims for refund of the tax shall comply with the following and any additional procedures as established by the Board:

(a) All claims shall be filed with the Superintendent of the Sacramento City Unified School District no later than one year after the date the tax was paid. The claimant shall file the claim within this time period and the claim shall be finally acted upon by the Board as a prerequisite to bringing suit thereon.

(b) Pursuant to Government Code section 935(b), the claim shall be subject to the provisions of Government Code sections 945.6 and 946.

(c) The Board shall act on a timely claim within the time period required by Government Code section 912.4.

(d) The procedure described in this Resolution, and any additional procedures established by the Board, shall be the exclusive claims procedure for claimants seeking a refund of the tax. The decision of the Board shall be final.

APPROVED, PASSED, AND ADOPTED by the Governing Board of the Sacramento City Unified School District this 1st day of August 2019, by the following vote, to wit:

AYES:

NOES:

ABSTAIN:

ABSENT:

President of the Board of Education

ATTEST:

Secretary of the Board of Education



SACRAMENTO CITY UNIFIED SCHOOL DISTRICT
COMMUNITY FACILITIES DISTRICT No. 2

SPECIAL TAX REPORT

FISCAL YEAR 2019-20

JULY 2019

PURSUANT TO THE MELLO-ROOS COMMUNITY FACILITIES ACT OF 1982

ENGINEER OF WORK:

SCIConsultingGroup

4745 MANGELS BOULEVARD

FAIRFIELD, CALIFORNIA 94534

PHONE 707.430.4300

FAX 707.430.4319

www.sci-cg.com

(THIS PAGE INTENTIONALLY LEFT BLANK)

TABLE OF CONTENTS

SUMMARY	1
ADMINISTRATION OF COMMUNITY FACILITIES DISTRICT	3
GENERAL ADMINISTRATIVE REQUIREMENTS.....	3
DELINQUENCY PROCEDURES.....	3
NOTICES OF SPECIAL TAX LIEN.....	3
REPORTING REQUIREMENTS	4
RATE AND METHOD OF APPORTIONMENT OF SPECIAL TAX.....	5
DISTRICT BOUNDARY DIAGRAMS.....	12
2019-20 SPECIAL TAX ROLL.....	16
EXHIBIT A - SPECIAL TAX NOTICE	17

SUMMARY

The Sacramento City Unified School District formed Sacramento City Unified School District Community Facilities District No. 2 (CFD #2) for the purpose of financing new and improved school facilities for students generated by new development within the District. CFD #2 was formed after receiving over two-thirds support (on an acreage voting basis) from property owners included within the Community Facilities District. The special tax proceeds from this CFD are being used to finance school construction bonds and / or provide public school facilities. This Report summarizes the fiscal year 2019-20 Special Tax, Method of Apportionment, and other related data.

There are currently 1,382 parcels in CFD #2, which includes both subdivided and non-subdivided parcels. As of June 30, 2019 1,330 building permits for new homes within the Community Facility District have been issued, 17 parcels have prepaid their CFD #2 tax obligation in full. The total annual special tax to be collected within CFD #2 for fiscal year 2019-20 is \$1,813,713. Table 1 summarizes the current and historical Special Tax data by year.

TABLE 1 - SUMMARY OF SPECIAL TAX LEVIES BY YEAR

Fiscal Year	Total Parcels	Total Parcels Taxed	Total Tax ¹
1998-99	469	393	\$196,990.14
1999-00	580	404	\$203,171.20
2000-01	579	415	\$221,988.44
2001-02	581	474	\$280,281.20
2002-03	578	536	\$343,608.30
2003-04	671	620	\$454,881.34
2004-05	953	861	\$753,486.22
2005-06	1202	1091	\$970,726.79
2006-07	1202	1150	\$1,060,729.52
2007-08	1205	1166	\$1,087,599.74
2008-09	1302	1181	\$1,156,744.20
2009-10	1299	1186	\$1,210,796.34
2010-11 ²	1299	1184	\$1,182,605.48
2011-12	1299	1201	\$1,230,718.74
2012-13	1298	1224	\$1,313,280.10
2013-14	1298	1261	\$1,394,193.84
2014-15	1382	1320	\$1,510,651.95
2015-16	1382	1329	\$1,580,953.65
2016-17	1382	1330	\$1,642,130.59
2017-18	1382	1330	\$1,683,786.37
2018-19	1382	1330	\$1,758,944.00
2019-20	1382	1330	\$1,813,713.09

¹ The total tax listed are the amounts submitted to the County Auditors (after any revisions for property changes).

² An audit of residential square footage resulted in a reduction in residential square footage of 214 parcels. In addition 11 homes prepaid their CFD 2 tax in full during fiscal year 2009-10.

Table 2 summarizes the number of parcels taxed each year, the total tax per year, and the corresponding mitigation rates applied for the year of parcel development.

TABLE 2 - SUMMARY OF SPECIAL TAX LEVIES BY YEAR

Year Built	Mitigation Rate Per New SFR ¹	Mitigation Rate Per New MFR	Parcels Taxed	Total Tax ²
1992-93	\$4.35	\$2.53	29	\$20,150.33
1993-94	\$4.55	\$2.66	3	\$3,711.35
1994-95	\$4.77	\$2.78	42	\$44,468.93
1995-96	\$5.00	\$2.91	1	\$1,409.25
1996-97	\$5.23	\$3.05	174	\$181,151.44
1997-98	\$5.48	\$3.20	141	\$148,683.69
1998-99	\$5.74	\$3.35	9	\$11,543.70
1999-00	\$6.02	\$3.51	12	\$17,708.66
2000-01	\$6.30	\$3.67	59	\$75,367.07
2001-02	\$6.60	\$3.85	65	\$92,352.72
2002-03	\$6.91	\$4.03	81	\$137,233.94
2003-04	\$7.24	\$4.22	261	\$405,137.92
2004-05	\$7.59	\$4.42	211	\$335,869.50
2005-06	\$7.95	\$4.63	60	\$98,891.82
2006-07	\$8.32	\$4.85	19	\$20,624.00
2007-08	\$8.72	\$5.08	2	\$3,880.40
2008-09	\$9.13	\$5.33	5	\$5,673.02
2009-10	\$9.57	\$5.58	11	\$11,941.93
2010-11	\$10.02	\$5.84	15	\$22,772.19
2011-12	\$10.49	\$6.11	23	\$27,011.27
2012-13	\$10.99	\$6.40	38	\$48,956.43
2013-14	\$11.51	\$6.70	59	\$84,461.35
2014-15	\$12.06	\$7.02	9	\$13,580.53
2015-16	\$12.63	\$7.36	1	\$1,131.65
2016-17	\$13.23	\$7.71	0	\$0.00
2017-18	\$13.86	\$8.07	0	\$0.00
2018-19	\$14.52	\$8.46	0	\$0.00
Total			1330	\$1,813,713.09

¹ The mitigation rate is the rate multiplied by residential square footage for the first fiscal year of new constructed SFR and MFR units. The multiplier is the rate at which the annual special tax is calculated by applying to the mitigation rates * assessable space minus any prepayments.

² The total tax and number of special tax units listed are the amounts submitted to the County Auditors (after any revisions for property changes).

ADMINISTRATION OF COMMUNITY FACILITIES DISTRICT

GENERAL ADMINISTRATIVE REQUIREMENTS

The Mello-Roos Community Facilities District Act of 1982 (the Act) requires that a Special Tax Report be prepared annually to identify the Special Tax Rate for all parcels to be assessed in the upcoming fiscal year. The levy data must subsequently be filed with the County Auditor before August 10 for inclusion on property tax bills.

After submission of the Special Tax levies, the final levies should be confirmed with the County Auditor prior to the preparation of tax bills, which typically occurs in October. The Special Tax is collected in two equal installments on the tax bills that are due on December 10 and April 10.

DELINQUENCY PROCEDURES

The District participates in the "Teeter Plan" whereby the Counties pay all delinquent special taxes to the District and in return the Counties institute collection proceedings and, when collected, keep all delinquent payments with interest and penalties. This plan allows the District to maintain reliable special tax revenues and reduces the cost of collection.

The District reviews the Tax Collector's public records annually by June 30 to determine the amount of special tax revenues and delinquencies during the fiscal year. If the amount of collections is less than 95% of the amount of special tax levy in such fiscal year, the School District has covenanted with bondholders to institute foreclosure proceedings no later than October 31 to enforce the lien against delinquent installments. The District is also obligated to institute foreclosure proceedings in the case of a single property owner who is delinquent by more than \$2,000. No property owner is currently delinquent by such amount and the delinquency rate on the special taxes is below 5%, so there is no requirement to commence foreclosure proceedings at this time.

NOTICES OF SPECIAL TAX LIEN

The Act states "For purposes of enabling sellers of real property subject to the levy of special taxes to satisfy the notice requirements of subdivision (b) of Section 1102.6 of the Civil Code, the designated office, department, or bureau shall furnish a Notice of Special Tax to any individual requesting the notice or any owner of property subject to a special tax levied by the local agency within five working days so receiving a request for such notice. The local agency may charge a reasonable fee for this service not to exceed ten dollars." A copy of this notice is included as Exhibit A.

In addition, any developer, subdivider or his or her agent or representative shall not sell or lease any property subject to the Special Tax until the prospective purchaser or lessee has been furnished with and signed a written notice of Special Tax Lien.

This notice is designed to clearly and accurately provide information about the special tax and the levy for the subject property.

SCI Consulting Group has developed a custom software system that will locate any property in the District and, among other functions, print customized notices of special tax lien. This software is included as a standard component of our administrative services.

REPORTING REQUIREMENTS

PUBLIC INFORMATION

Property owners and other interested persons can obtain information regarding special tax levies and other information by contacting the District or SCI Consulting Group at telephone number (800) 273-5167. The telephone number for SCI Consulting Group is also included with property tax bills.

ASSESSOR AND AUDITOR FILING AND REPORTING

Pursuant to the Act, the Mello-Roos Community Facilities Annual Report along with all special tax levies for the upcoming fiscal year must be filed with the County Auditor by August 10. The report and special tax levies will be submitted and confirmed for the fiscal year 2019-20.

CDIAC REPORTING

Article 53359.5 of the Act stipulates that any bonds sold on or after January 1, 1993 must provide the California Debt and Investment Advisory Commission (CDIAC) with annual reports not later than October 30, including the following information:

1. The principal amount of any bonds outstanding.
2. The balance in the bond reserve fund.
3. The balance in the capitalized interest fund, if any.
4. The number of parcels which are delinquent with respect to their special tax payments, the amount that each parcel is delinquent, the length of time that each has been delinquent, and when foreclosure was commenced for each delinquent parcel.
5. The balance in any construction funds.
6. The assessed value of all parcels subject to the special tax to repay the bonds as shown on the most recent equalized roll.

RATE AND METHOD OF APPORTIONMENT OF SPECIAL TAX

EXHIBIT B - THE SPECIAL TAX FORMULA

SACRAMENTO CITY UNIFIED SCHOOL DISTRICT COMMUNITY FACILITIES DISTRICT NO.2 RATE AND METHOD OF APPORTIONMENT

A Special Tax, determined as described below, shall be levied each Fiscal Year by the Sacramento City Unified School District (the "District") within the boundaries of Community Facilities District No.2 ("CFD No. 2") to pay the Authorized Costs of the CFD No. 2, in accordance with the terms and conditions set forth herein.

1. Definitions. The following definitions shall apply:
 - A. "Assessable Space" means a quantity equal to the area (expressed in square feet) within the perimeter of a residential structure, not including any carport, walkway, garage, overhang, patio, enclosed patio, detached accessory structure or similar structure. This quantity shall be determined by the Superintendent in accordance with the standard practice used by the building department of the city or county issuing the building permit when calculating structural perimeters.
 - B. "Assessor's Parcel" ("Parcel") means a parcel of land designated on a map of the Sacramento County Assessor and assigned a discrete identifying number.
 - C. "Authorized Costs" means all authorized costs and expenses of the CEO set forth by law, and all costs necessary to administer the bonds, collect and administer the special taxes, and administer the CFD, including but not limited to funds to pay current debt service on the bonds, to accumulate funds for future debt service, to pay amounts delinquent on the bonds (or to become delinquent based upon past special tax delinquencies), to replenish the reserve fund to its proper level (or to reimburse payment to be made from the reserve fund based upon past special tax delinquencies), to pay directly for any authorized facilities or to accumulate funds for that purpose.
 - D. "Board" means the District's and CFD's Governing Board.
 - E. "CFD" or "CFD No. 2" means the Community Facilities District No. 2 of the Sacramento City Unified School District.
 - F. "District" means the Sacramento City Unified School District.
 - G. "Escalation Factor" means a rate of not more than 4.75 % per annum to be annually determined by the Board at the time taxes are levied and to be used to

calculate the Mitigation Rate.

- H. "Fiscal Year" means the period starting on July 1 and ending on the following June 30, except that the first Fiscal Year shall commence on the date the Board adopts the Resolution of intention to form CFD No. 2 and shall end on the next succeeding June 30.
 - I. "Mitigation Rate" means, for calculations of the Special Tax payable in the first Fiscal Year, with respect to Multifamily Residential Property, \$2.42 per square foot of Assessable Space and, with respect to Single Family Residential Property, \$4.15 per square foot of Assessable Space and, for calculations of the Special Tax payable in each Fiscal Year thereafter, such amounts increased each Fiscal Year by the Escalation Factor and otherwise adjusted as provided in Section (B) hereof.
 - J. "Multifamily Residential Property" means Residential Property for which a building permit for multifamily dwelling units is expected to be issued.
 - K. "Residential Property" ("Property") means an Assessor's Parcel within CFD No. 2 that is zoned for residential use.
 - L. "Single Family Residential Property" means Residential Property for which a building permit for a single family detached dwelling unit is expected to be issued.
 - M. "Special Tax" means the special tax or special taxes authorized to be levied within CFD No. 2.
 - N. "Superintendent" means the District Superintendent or the Superintendent's designee.
 - O. "Tax Collection Schedule" means document to be prepared annually by the Superintendent for use by the Sacramento County Auditor in collecting the annual installments of the Special Tax each Fiscal Year.
 - P. "Tax-Exempt Property" means any property within CFD No. 2 that in accordance with Section 2 hereof will not be taxed.
 - Q. "Territory to be Annexed" means any territory that is within District boundaries but not included within the boundaries of CFD No. 2 upon formation.
2. Tax-Exempt Property:

Governmental property owned by the state, federal or other local governments will not be taxed except:

- A. If a public agency owning property including property held in trust for any beneficiary, that is exempt from a special tax pursuant to Government Code Section 53340 grants a leasehold after January 1, 1988, or other possessory interest in the property to a nonexempt person or entity, the Special Tax shall, notwithstanding Government Code Section 53340, be levied in the leasehold or possessory interest and shall be payable by the owner of the leasehold or possessory interest.
- B. If property not otherwise exempt from a special tax is acquired by a public entity other than the District through a negotiated transaction, or by gift or devise, the Special Tax shall, notwithstanding Government Code Section 53340, continue to be levied on the property acquired and shall be enforceable against the public entity that acquired the property.
- C. If property subject to a special tax is acquired by a public entity through eminent domain proceedings, the obligation to pay the Special Tax shall be treated as if it were a special annual assessment. For this purpose, the present value of the obligation to pay the Special Tax to pay the principal and interest on any indebtedness incurred by the CFD prior to the date of apportionment determined pursuant to Section 5082 of the Revenue and Taxation Code shall be treated the same as a fixed lien special assessment.

Parcels that are not Residential Property shall not be taxed

3. Classification of Property. Determination of Tax Rates and Levy of Special Tax.

- A. At the beginning of each Fiscal Year, the Superintendent shall classify each Assessor's Parcel in CFD No. 2 as Tax-Exempt Property or as either Multifamily or Single Family Residential Property by reference to the standard practices of the city or county issuing building permits (or similar authorizations) for such Parcel.
- B. At the time taxes are levied each Fiscal Year, the Board shall determine the Escalation Factor and calculate the Mitigation Rate applicable for such Fiscal Year.
- C. At the beginning of each Fiscal Year, the Board shall levy the Special Tax as follows:
 - (1) For Tax-Exempt Property, no tax shall be levied.
 - (2) For each parcel for which a building permit issues during such Fiscal Year, the Board shall levy the Special Tax in an amount equal to the product of the Mitigation Rate and the Assessable Space of such Parcel.

If, after the annual levy and before a building permit is issued, a Parcel ceases to be or becomes Tax-Exempt Property or changes its classification from Single Family Residential Property to Multifamily Residential Property or from Multifamily Residential Property to Single Family Residential Property, then the Board shall revise the Special Tax to be levied against such Parcel.

4. Payment of the Special Tax.

- A. The Special Tax is due upon the issuance of a building permit, or similar authorization for mobilehomes, for any Residential Property. Payment shall be made to the Superintendent by cashier's check or certified check payable to the CFD, and the Superintendent shall issue a receipt for payment showing the date and amount. If the Special Tax is not paid in Full, or if the owner elects (in accordance with the requirements of subsection B below) to pay all or part of the amount due in annual installments, the amount of the Special Tax that remains unpaid (the "Carryover Amount") shall be payable in annual installments (with interest) over a thirty-year period, calculated as described in subsection C below.
- B. A Parcel owner may elect to pay the Special Tax in annual installments. Such election shall be made at the time a building permit or similar authorization for the Parcel is issued, shall be in writing on a form provided by the Superintendent, and shall be accompanied by payment of any part of the Special Tax that such owner elects to pay immediately.
- C. If all or part of the Special Tax will be paid in annual installments, the amount payable in each year after the Special Tax has become due shall be the product of the Carryover Amount and the installment factor listed in the table below for such year:

Year Following Issuance of Building Permit	Installment Factor	Prepayment Factor
1	0.07	1.00
2	0.07	1.02
3	0.07	1.04
4	0.07	1.05
5	0.08	1.07
6	0.08	1.09
7	0.08	1.10
8	0.08	1.11
9	0.09	1.12
10	0.09	1.13
11	0.09	1.14
12	0.10	1.14
13	0.10	1.14
14	0.10	1.14
15	0.11	1.13
16	0.11	1.12
17	0.11	1.11
18	0.12	1.09
19	0.12	1.06
20	0.13	1.03
21	0.13	0.99
22	0.14	0.94
23	0.14	0.89
24	0.15	0.82
25	0.15	0.74
26	0.16	0.66
27	0.16	0.56
28	0.17	0.44
29	0.17	0.31
30	0.18	0.17

- D. At the beginning of each Fiscal Year, beginning in 1992-93, the Superintendent shall prepare a Tax Collection Schedule that includes the amount of annual installments of Special Taxes to be collected in such Fiscal Year. The Superintendent shall present the Tax Collection Schedule to the Board for its approval. The Superintendent shall deliver the Tax Collection Schedule, as approved by the Board, to the Sacramento County Auditor and request the Auditor to place the annual installments on the secured property tax rolls for the current Fiscal Year. The Superintendent shall deliver the Tax Collection Schedule to the Auditor not later than the date required by the Auditor for such inclusion.

5. Collection of Installments of the Special Tax

Installments of the Special Tax that are to be collected annually shall be collected upon the applicable Assessor's Parcels in the CFD in the same manner as ordinary ad valorem property taxes are collected and in accordance herewith; provided, however, that the CFD may collect installments at a different time or in a different manner if necessary to meet its financial obligations. All annual installments of Special Taxes shall be subject to the same penalties and lien priorities in the case of delinquency as is provided for ad valorem taxes. The Board shall cause the actions required above to be done for each Fiscal Year in a timely manner to assure that the Tax Collection Schedule is received by the Auditor of the County of Sacramento for inclusion with billings for ad valorem taxes for the applicable Fiscal Year.

6. Termination of the Special Tax.

The owner of a Parcel for which the Special Tax was not paid in full when due may, at any time thereafter, pay and permanently satisfy the Special Tax levied against such Parcel by paying to the Superintendent, by cashier's check or certified check payable to the CFD, an amount equal to the product of the Carryover Amount and the prepayment factor for the Fiscal Year in which such payment is made as shown in the table under paragraph 4(C) above.

In the event the Special Tax has been paid and permanently satisfied with respect to a Parcel, the Board shall record a Notice of Cancellation of Special Tax Lien as to that Parcel pursuant to Section 53344 of the Government Code. The Notice of Cancellation of Special Tax Lien shall identify with particularity the Special Tax that has been paid and permanently satisfied, shall contain the book and page number in the records of the county recorder where the Notice of Special Tax Lien being canceled is recorded, shall contain the legal description and assessor's parcel number of the particular Parcel of land subject to the lien, and shall contain the name of the owner of record of the Parcel. The Board may specify a charge payable by the owner of record for the preparation and recordation of this notice.

7. Appeals and Interpretation Procedure.

Any taxpayer subject to the Special Tax claiming that the amount or application of the Special Tax or an annual installment thereof has not been properly computed may file a notice with the Superintendent appealing the levy or collection of the Special Tax or annual installment. The Superintendent will promptly review the appeal and, if necessary, meet with the applicant and decide the appeal. If the findings of the Superintendent verify that the tax should be modified or changed, the Tax Collection Schedule shall be corrected if necessary and, if applicable, a refund shall be granted in accordance with Section 8 hereof. Any dispute over the decision of the Superintendent shall be referred to the Board, and the decision of the Board with respect to the Special Tax or annual installment shall be final.

Interpretation may be made by resolution of the Board for purposes of clarifying any vagueness or uncertainty as it relates to the application of the Special Tax rate, the calculation of the amount of any annual installment or prepayment amount, the application of the method of apportionment, the classification of Parcels, or any definition applicable to the CFD.

8. Claim for Refund.

All claims for refund of Special Tax (or annual installment thereof) collected on behalf of the CFD shall be filed with the Superintendent not later than one year after the date the Special Tax (or annual installment) has been paid to the County or to the Superintendent on behalf of the CFD in cases where the tax is not collected by the County. The claimant shall file the claim within this time period, and the claim shall be finally acted upon by the Board as a prerequisite to the claimant's bringing suit thereon. Pursuant to Government Code section 935(b), the claim shall be subject to the provisions of Government Code sections 945.6 and 946.

The Board acting on its own behalf and on behalf of the CFD shall respond to a timely claim within the time period required and in the manner specified by Government Code sections 912.4 and 912.6. Should said sections be amended or repealed, they shall apply according to their terms in effect on July 1, 1991.

The procedure described herein shall be the exclusive procedure for claimants' seeking a refund of Special Tax (or annual installments thereof). The decision of the District in response to any claim for refund shall be final.

9. Annexation of Territory.

Any territory to be annexed to the CFD shall, in addition to payment of Special Taxes at the rates set forth above, be subject to payment of any costs incurred by the CFD and District in conducting the annexation process and such additional tax within the territory to be annexed as may be necessary to compensate for the interest and principal previously paid by the existing community facilities district; provided that in no event shall the additional tax authorized herein be allowed to exceed the Special Tax applicable to the Parcels being annexed.

DISTRICT BOUNDARY DIAGRAMS

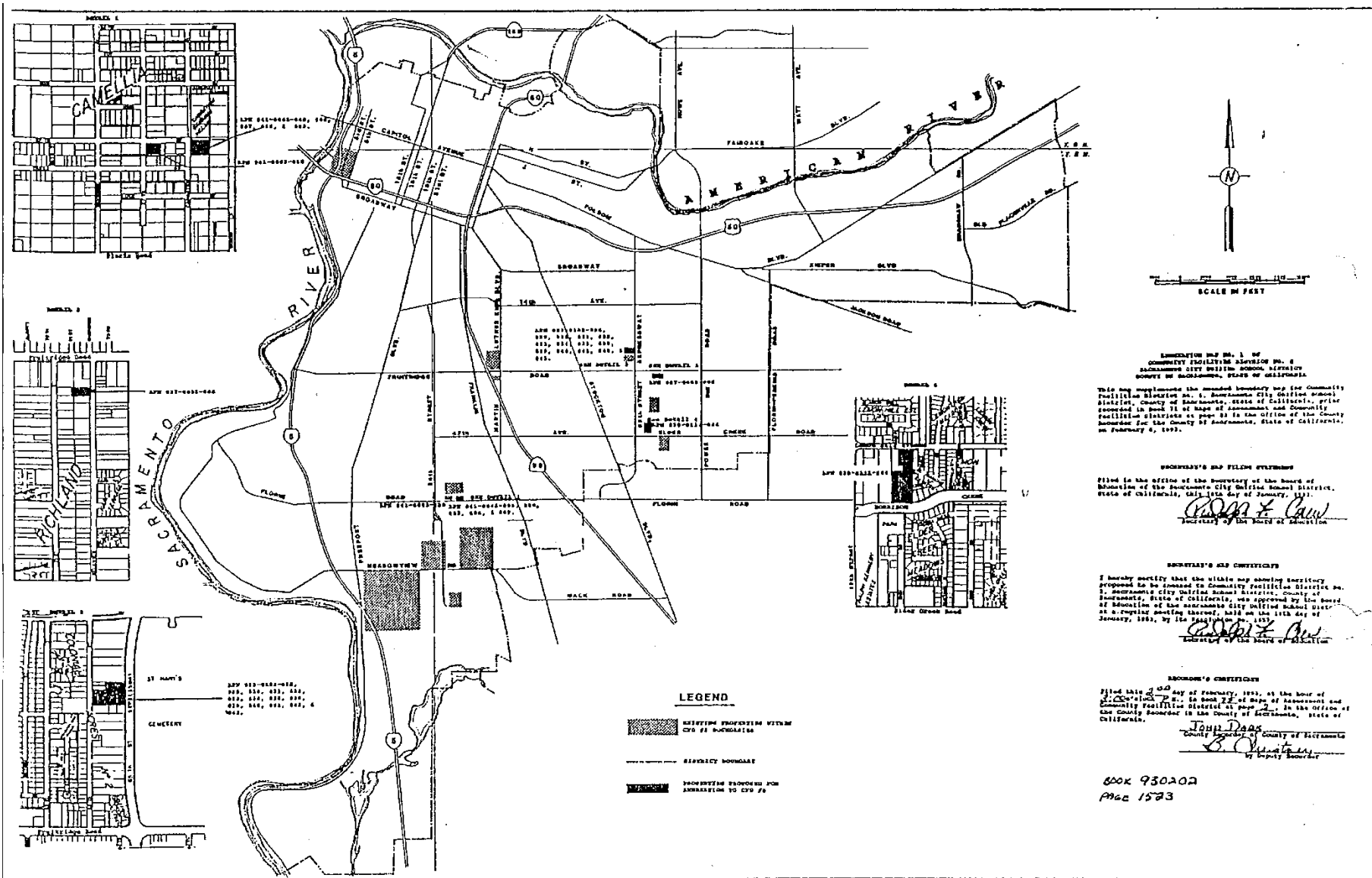

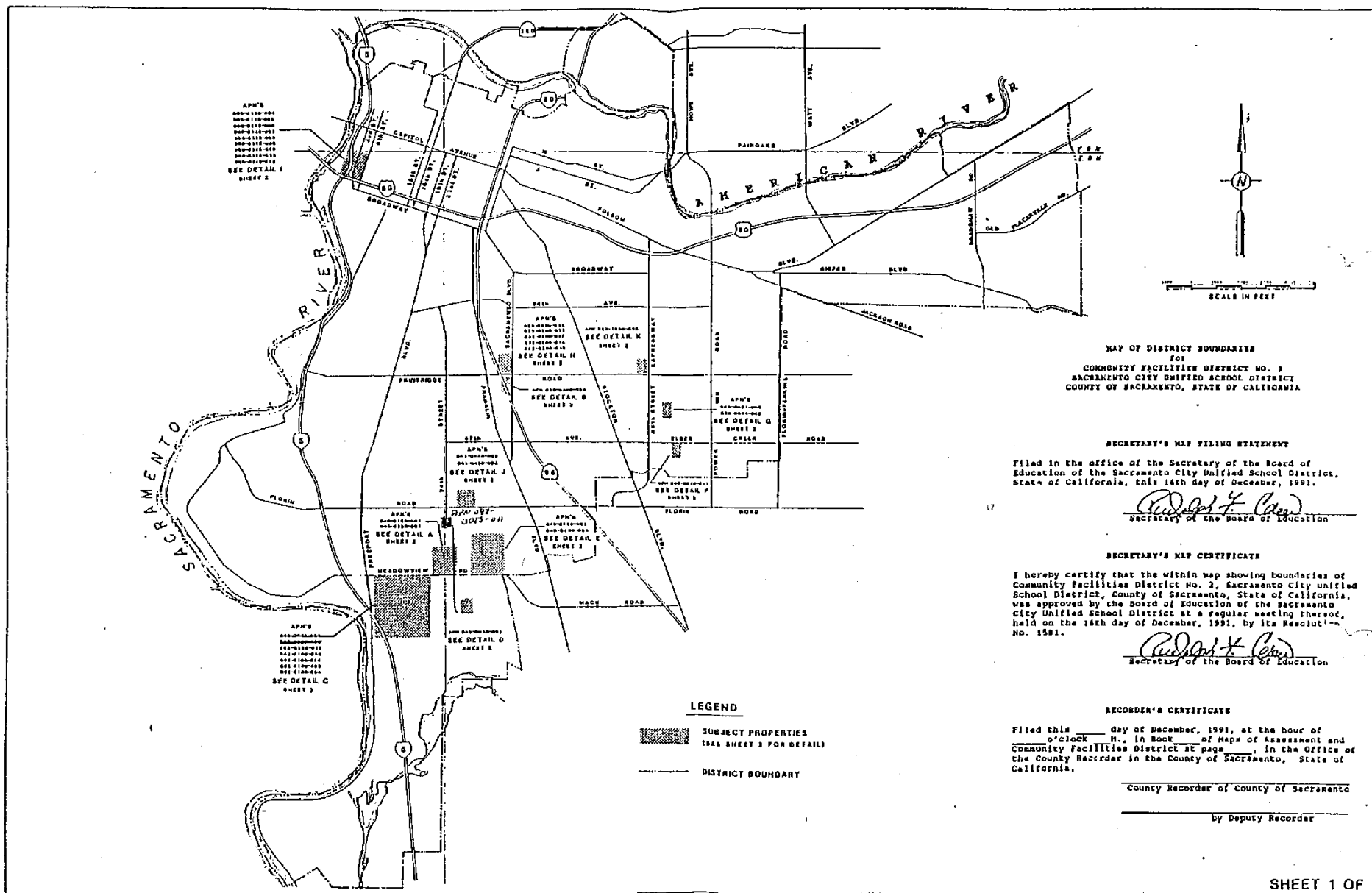

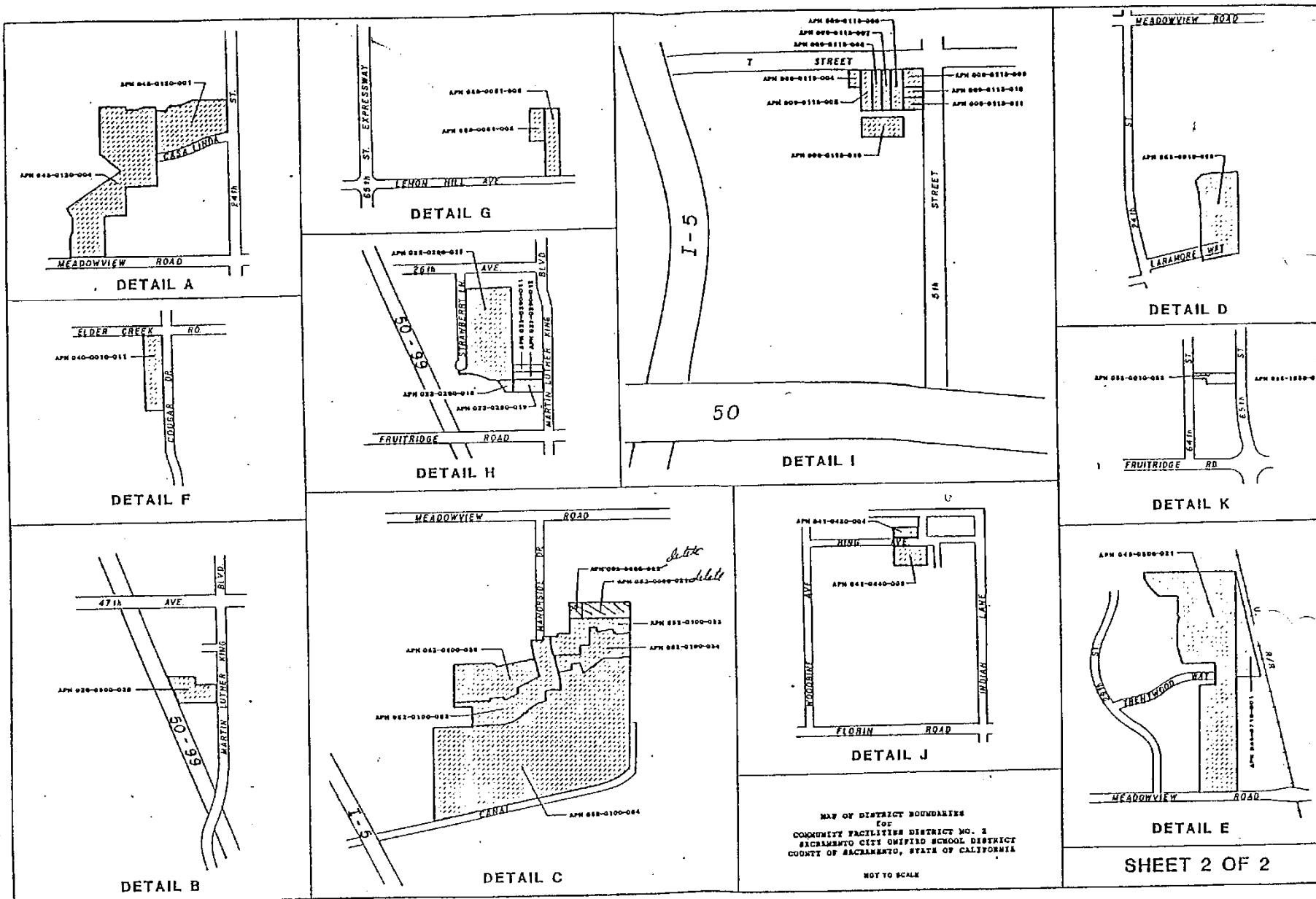

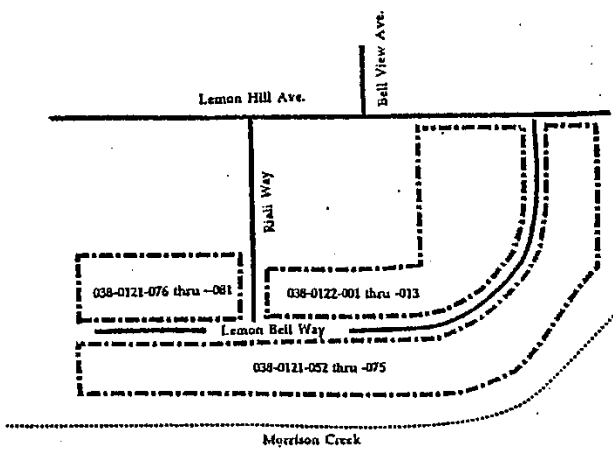

LEGEND
 Local Streets
 Boundary Lines
 Creek
 Parcel Numbers

SECRETARY'S MAP FILING STATEMENT

FILED IN THE OFFICE OF THE SECRETARY OF THE BOARD OF THE SACRAMENTO CITY UNIFIED SCHOOL DISTRICT, STATE OF CALIFORNIA, THIS ____ DAY OF _____, 1998.

SECRETARY OF THE BOARD

SECRETARY'S MAP CERTIFICATE

I DO HEREBY CERTIFY THAT THE WITHIN MAP SHOWING THE PROPOSED BOUNDARIES OF ANNEXATION NO. 4 TO THE COMMUNITIES FACILITIES DISTRICT NO. 2, SACRAMENTO CITY UNIFIED SCHOOL DISTRICT, COUNTY OF SACRAMENTO, STATE OF CALIFORNIA, WAS APPROVED BY THE BOARD OF TRUSTEES OF THE FAIR SACRAMENTO CITY UNIFIED SCHOOL DISTRICT AT A MEETING THEREOF, HELD ON ____ DAY OF _____, 1998 BY ITS RESOLUTION NO. _____.

SECRETARY OF THE BOARD

RECORDER'S CERTIFICATE

FILED THIS ____ DAY OF _____, 1998 AT THE HOUR OF ____ O'CLOCK ____ M. IN BOOK ____ OF MAPS OF ASSESSMENT AND COMMUNITY FACILITIES DISTRICTS AT PAGE ____ IN THE OFFICE OF THE COUNTY RECORDER IN THE COUNTY OF SACRAMENTO, STATE OF CALIFORNIA.

COUNTY RECORDER, COUNTY OF SACRAMENTO

NOTE

REFERENCE IS HEREBY MADE TO THE MAPS AND DEEDS OF RECORD IN THE OFFICE OF THE ASSESSOR OF THE COUNTY OF SACRAMENTO FOR A DETAILED DESCRIPTION OF THE LINES AND DIMENSIONS OF ANY PARCELS SHOWN HEREIN. THOSE MAPS SHALL COVER FOR ALL DETAILS CONCERNING THE LINES AND DIMENSIONS OF SUCH PARCELS. EACH PARCEL IS IDENTIFIED BY SAID MAPS BY ITS DISTINCTIVE ASSESSOR'S PARCEL NUMBER.

MAP OF PROPOSED BOUNDARY ANNEXATION NO. 4

**SACRAMENTO CITY UNIFIED SCHOOL DISTRICT
 COMMUNITY FACILITIES DISTRICT NO. 2
 CITY OF SACRAMENTO, SACRAMENTO COUNTY,
 CALIFORNIA**

Slatts Consultants, Inc.
 2309 Boynton Ave., Suite 201
 Fairfield, CA 94533
 707-416-5016

2019-20 SPECIAL TAX ROLL

The tax roll listing the fiscal year 2019-20 Special Tax for all Assessor's Parcels of land within the boundaries of the Community Facilities District No. 2 (CFD #2) of the Sacramento City Unified School District has been filed with the District and is included herein by reference. The tax attributed to each parcel was computed in accordance with the Rate and Method of Apportionment of Special Tax summarized beginning on Page 8.

Any parcels within CFD #2 for which building permits for residential construction were not issued as of June 30, 2019 are not taxed for the 2019-20 fiscal year. These parcels are shown with a \$0.00 Annual Special Tax on the Tax Roll. Any governmentally owned parcels are also listed with a \$0.00 Special Tax.

SACRAMENTO CITY UNIFIED SCHOOL DISTRICT
Community Facilities District No. 2
2019-2020
Special Tax Roll

Assessor Parcel Number	Owner	Site Address	Square ft.	CFD #2 Tax
00900720230001	GAVRIC JELISAVETA	923 T	1485	720.23
00900720230002	BARBERO JEANA E/CATHERINE E	925 T	1485	720.23
00900720230003	FONG LESLIE W	927 T	1485	720.23
00900720230004	AYE MARY/AYE MICHAEL	929 T	1485	720.23
00900720230005	LEE JANET WAIMIN	931 T	1803	874.46
00900720230006	LEMEI GALEN D	1916 10TH	1485	720.23
00900720230007	SNYDER MICHAEL H	1918 10TH	1485	720.23
00900720230008	FONG GRANT WAYNE	1920 10TH	1485	720.23
00900720230009	ELDRIDGE KRISTEN	1922 10TH	1485	720.23
00900720230010	JENKINS MARK EDWARD/PAUL	1924 10TH	1647	798.80
00900720230011	LIM JOHNNY J/SUSAN D	1926 10TH	1485	720.23
00900720230012	LUONG JENNIFER M	1928 10TH	1485	720.23
00900720230013	JERRY & LORRAINE HUANG LIVING	1930 10TH	1485	720.23
00901130160001	ROTH DEBRA L	432 T	649	270.63
00901130160002	MARK A/THERESA	430 T	1306	544.60
00901130160003	MAY FAMILY TRUST	428 T	1306	544.60
00901130160004	HUFF GWEN M	426 T	750	312.75
00901130160005	RUSSELL BEN WADE/LAURA LYNN	424 T	640	266.88
00901130160006	PARSONS REBECCA LORENE	422 T	1306	528.67
00901130160007	COLEMAN AFSHIN/LAMAIA	420 T	1306	528.67
00901130160008	RYAN PATRICIA M	418 T	649	270.63
00901130290001	TRAINOR WILLIAM P/LAURISA S	416 T	1306	544.60
00901130290002	CRANDALL-BEAR JOANNE/DALE	414 T	1306	544.60
00901130290003	OSBORN JULIA K/ROBERT B	408 T	1410	570.77
00901130290004	COAN GRACE I	406 T	993	414.08
00901130290005	FRANSEN MICHELLE FIELDS	404 T	1019	424.92
00901130290006	DELSON SAM A	410 T	1051	425.44
00901130290007	AURIEMMA JASON/ANN MARIE	412 T	1410	570.77
00901130290008	DAVID L MANDEL REVOCABLE	440 T	1410	570.77
00901130290009	GOLDBERG LOAIZA TRUST	442 T	1051	425.44
00901130290010	KOCHAN JUSTIN H	444 T	1051	425.44
00901130290011	MAGAVERN WILLIAM/SARA S	446 T	1410	570.77
00901130290014	DONALD L KNUTSON TRUST	2004 5TH	1051	425.44
00901130290015	CLANCY AMY J/SEAN	2008 5TH	1410	570.77
00901130290016	KASHMIRI MOHAMMAD N/KATIE A	438 T	1306	528.67
00901130290017	ELSEA MEGAN/PAUL TRUDEAU	436 T	1306	528.67
02202900170000	SACRAMENTO CITY UNIFIED	5201 STRAWBERRY	0	0.00
02202900200000	PARADISE MISSIONARY BAPTIST	5240 MARTIN LUTHER KING	0	0.00
02301520280000	LEDUONG LIVING TRUST	5051 STONER	1108	837.65
02301520290000	CARMONA GONZALI NORMA	5061 STONER	1108	837.65
02301520300000	DESILVA LISA J/PATRICK	5071 STONER	1108	877.54
02301520310000	SWEITZER LORRIE J	5081 STONER	1108	877.54

SACRAMENTO CITY UNIFIED SCHOOL DISTRICT
Community Facilities District No. 2
2019-2020
Special Tax Roll

Assessor Parcel Number	Owner	Site Address	Square ft.	CFD #2 Tax
02301520320000	POSAS JOANNE P	5091 STONER	1108	877.54
02301520330000	PARKS RANDY/KAREN	5050 STONER	1136	858.82
02301520340000	ACACIA STREET HOMES LLC	5060 STONER	1208	840.77
02301520350000	OROZCO FRANCISCO/MARIA G	5090 STONER	1210	842.16
02301520380000	OKAZAKI JANE	5065 64TH	1368	1083.46
02301520390000	FUNES RUTH A	5069 64TH	1210	842.16
02301520400000	BADILLO ALEJANDRO	5094 STONER	1210	842.16
02301520410000	MOUA LAO/THUY M VUONG	5098 STONER	1210	842.16
02301520420000	PARSONS JANICE MAEM/MICHAEL	5095 STONER	1210	842.16
02301520430000	ANGENENT SAMUEL V	5099 STONER	1210	842.16
02301630260000	EWING JORDAN W/KELSI B KIMBLE	5351 64TH	680	486.54
02603000380000	NUNEZ KERI LYNN/MANUEL	5730 MARTIN LUTHER KING	0	0.00
02700520050000	PHONG ENTERPRISE LLC	5650 BELLEVIEW	4637	2248.95
03500100550000	CITY OF SACRAMENTO	6432 PARK VILLAGE	0	0.00
03500100560000	CITY OF SACRAMENTO	PARK VILLAGE	0	0.00
03500100570000	CITY OF SACRAMENTO	PARK VILLAGE	0	0.00
03503800010000	GIBSON ERIN M	5900 PARK VILLAGE	1753	1332.46
03503800020000	YEE LARRY B/GRACE SEO	5906 PARK VILLAGE	1975	1501.20
03503800030000	WOODFORK LINDA/ADRIAN	5912 PARK VILLAGE	2207	1677.54
03503800040000	MACIEL ANTHONY/CHERYL A	5918 PARK VILLAGE	1574	1196.40
03503800050000	TERAMOTO SEAN	5924 PARK VILLAGE	2679	1798.40
03503800060000	HUNT JEFFERY/PAMELA	5930 PARK VILLAGE	2650	1710.99
03503800070000	GRIFFIN IAN	5936 PARK VILLAGE	2774	2108.52
03503800080000	HE CHIAN/TERRENCE B OHLER	5942 PARK VILLAGE	2207	1677.54
03503800090000	WATT SAMIRA COLLIER/BRIAN	5948 PARK VILLAGE	1753	1332.46
03503800100000	DIANE M MATTHEWS FAMILY TRUST	5954 PARK VILLAGE	2894	1896.45
03503800110000	EBBERT BRIAN S/IRENE VILLARRUZ	5960 PARK VILLAGE	2177	1654.74
03503800120000	GREGORY/KIMBERLEE BEYRER	5966 PARK VILLAGE	2650	1710.99
03503800130000	KATO MARIA A	5972 PARK VILLAGE	1975	1501.20
03503800140000	WHITFIELD NINA L	5978 PARK VILLAGE	2774	2108.52
03503800150000	CITY OF SACRAMENTO	PARK VILLAGE	0	0.00
03503900010000	XING WEI/BRENDA	5984 PARK VILLAGE	2894	1896.45
03503900020000	PHYLLIS M BEYRER LIVING TRUST	5990 PARK VILLAGE	2207	1677.54
03503900030000	HAKIM CORNELIS M/CHITRA K	5996 PARK VILLAGE	2774	2108.52
03503900040000	PHUNG V HOANG TRUST	6002 PARK VILLAGE	2894	1896.45
03503900050000	ROMO GREGORIO JR	6008 PARK VILLAGE	1975	1501.20
03503900060000	LEYVA GUILLERMO/MARTHA	6014 PARK VILLAGE	2774	2108.52
03503900070000	MORISAWA KEVIN T/LURDES L	6020 PARK VILLAGE	2251	1710.99
03503900080000	SANCHEZ DEBBIE	6026 PARK VILLAGE	2207	1677.54
03503900090000	GUTIERREZ ERIK/VICTORIA	6032 PARK VILLAGE	2679	1798.40
03503900100000	FONG FAMILY TRUST	6038 PARK VILLAGE	2894	1896.45
03503900110000	CARRASCO VERONICA	18 SHADY PARK	1574	1196.40

SACRAMENTO CITY UNIFIED SCHOOL DISTRICT
Community Facilities District No. 2
2019-2020
Special Tax Roll

Assessor Parcel Number	Owner	Site Address	Square ft.	CFD #2 Tax
03503900120000	FLATH JOHN/SHARON	17 SHADY PARK	1753	1332.46
03503900130000	BAJORIN MURPHY FAMILY TRUST	11 SHADY PARK	2177	1654.74
03503900140000	YEE GENIE	5 SHADY PARK	2207	1677.54
03503900150000	WOO EDWIN/JENNIFER	4 PARK TREE	1975	1501.20
03503900160000	NGUYEN HOANG A/THU M	10 PARK TREE	2207	1677.54
03503900170000	CHAN KARL K/KATHRYN N	16 PARK TREE	2774	2108.52
03503900180000	YEE ELLEN	17 PARK TREE	1975	1501.20
03503900190000	ARTHUR/CHERYL CHAN FAMILY REV	11 PARK TREE	2774	2108.52
03503900200000	CHANG ROLAND/DENISE TAM	5 PARK TREE	2894	1896.45
03503900210000	OSBORN PHILLIP/JENNIFER	6 PARK BROOK	1975	1501.20
03503900220000	SHIJO DEBORAH N/MUROKO	12 PARK BROOK	2207	1757.65
03503900230000	ALTARE CRAIG R/HEATHER R	18 PARK BROOK	2774	2108.52
03503900240000	GREELEY NATHANIEL R/DARYL S	19 PARK BROOK	2894	1896.45
03503900250000	BAREFIELD ANN M	15 PARK BROOK	1975	1501.20
03503900260000	IBARRA ROBERT M/VICKI T	7 PARK BROOK	2207	1757.65
03504000010000	ODANIEL MELISSA	1511 43RD	1753	1396.09
03504000020000	NAGAO SETSUKO/KEIKO	1501 43RD	1574	1253.53
03504000030000	CHUK SUM C/JACKY	1491 43RD	1975	1572.89
03504000040000	WONG TIMOTHY LEO/MORENA	1490 43RD	2177	1654.74
03504000050000	LEUNG DAVID/STANLEY	1500 43RD	1753	1332.46
03504000060000	PEREZ SALVADOR/BLANCA	1510 43RD	1574	1196.40
03504000070000	LEE ERIC/CECILIA W	4 HERITAGE PARK	2650	1710.99
03504000080000	UMEMOTO KEITH K/PAULA A	10 HERITAGE PARK	2774	2108.52
03504000090000	PIEDRA SULLIVAN MERCEDES	16 HERITAGE PARK	1975	1501.20
03504000100000	VIEN WILLIAM	17 HERITAGE PARK	2774	2108.52
03504000120000	TAM-TOY LYNN/PHILIP TOY	5 HERITAGE PARK	2894	1896.45
03504000130000	CARLSON FAMILY TRUST	6 ZOOLANDER	2207	1677.54
03504000140000	SOOHOO FAMILY TRUST	12 ZOOLANDER	2894	1896.45
03504000150000	REYES RAMON S JR/DAISY M GEE	18 ZOOLANDER	2774	2108.52
03504000160000	GREER FAMILY LIVING TRUST	19 ZOOLANDER	2177	1733.76
03504000170000	SAELEE KALVIN E/MUANG K	15 ZOOLANDER	1975	1501.20
03504000180000	MORRIS LOU E	7 ZOOLANDER	2177	1654.74
03504000190000	JAMES P/LAURA M ENGLANDER	2 HIDDEN PARK	1975	1501.20
03504000200000	KIM V KELSEY REVOCABLE TRUST	8 HIDDEN PARK	2774	2108.52
03504000210000	MAR DEAN H	12 HIDDEN PARK	2894	1896.45
03504000220000	2017 2 IH BORROWER LP	15 HIDDEN PARK	2774	2108.52
03504000230000	WATKINS SANDRA L	7 HIDDEN PARK	1753	1332.46
03504000240000	E V GARCIA 2011 REVOCABLE	1 HIDDEN PARK	2650	1710.99
03504000250000	JEW DARREN E/CHING	4 LAND VIEW	2894	1896.45
03504000260000	DENNIS L & KAREN S GEYER	10 LAND VIEW	1753	1332.46
03504000270000	GEE LESTER	16 LAND VIEW	2177	1654.74
03504000280000	EASTON RONALD/LATRENDIA	17 LAND VIEW	2650	1710.99

SACRAMENTO CITY UNIFIED SCHOOL DISTRICT
Community Facilities District No. 2
2019-2020
Special Tax Roll

Assessor Parcel Number	Owner	Site Address	Square ft.	CFD #2 Tax
03504000290000	NARESH LACHMI	6300 PARK VILLAGE	2207	1677.54
03504000300000	RICE JULIET	6306 PARK VILLAGE	1975	1501.20
03504000310000	WEITZMAN DANIEL CHARLES/RANDI	6312 PARK VILLAGE	2894	1896.45
03504100010000	SHIMAZU STEPHANIE K/BRIAN P	6318 PARK VILLAGE	2774	2108.52
03504100020000	GARLICK LORIE E	6324 PARK VILLAGE	2207	1677.54
03504100030000	FERGUSON WILLIAM M JR/MAY	6330 PARK VILLAGE	2774	2108.52
03504100040000	WINARDI RICKY	6336 PARK VILLAGE	2495	1896.45
03504100050000	MATSUMOTO JAY T/SAMANTHA M	6342 PARK VILLAGE	2207	1677.54
03504100060000	MICHAEL REYES TRUST 2004	6348 PARK VILLAGE	2251	1710.99
03504100070000	GUTIERREZ	6354 PARK VILLAGE	2774	2108.52
03504100080000	MACALUSO ANITA M	6360 PARK VILLAGE	1753	1332.46
03504100090000	ALEXANDER ELIZABETH S/NORMAN	6366 PARK VILLAGE	2177	1654.74
03504100100000	HOLLAND TONI M	6372 PARK VILLAGE	1975	1572.89
03504100110000	SERRATO JOSE/LETICIA	6378 PARK VILLAGE	2650	1792.70
03504100120000	VANEGAS ROBERTO	6384 PARK VILLAGE	2207	1757.65
03504100130000	WONG KATHY Y	6390 PARK VILLAGE	1753	1396.09
03504100140000	SULLIVAN KATHLEEN A	6396 PARK VILLAGE	2679	1884.28
03504100150000	MACALUSO ROBERT A	6402 PARK VILLAGE	1975	1572.89
03504100160000	VALLEJO LILIA/SALVADOR	6408 PARK VILLAGE	2177	1733.76
03504100170000	CURLETTE MATTHEW	6414 PARK VILLAGE	2207	1757.65
03504100180000	DIANA GIN REVOCABLE LIVING	6420 PARK VILLAGE	1753	1396.09
03504100190000	GONZALES ELISA	6426 PARK VILLAGE	1975	1572.89
03800510430000	GARCIA EMILY/MANUEL O ELIZALDE	6090 71ST	1956	1478.74
03800510440000	SOU MIMI	6084 71ST	2081	1628.59
03800510450000	VO THU	6076 71ST	2105	1647.37
03800510460000	VONG HIN	6060 71ST	1750	1323.00
03800510470000	YOUNG ROBERT/STEVE T	7121 GIFT	2105	1614.96
03800510480000	YU LI X	7131 GIFT	2105	1614.96
03800510490000	SAECHAO YAO V/KOY S	7141 GIFT	2105	1570.75
03800510500000	LAM MUOI/DIANE LUONG	7151 GIFT	2105	1614.96
03800510510000	NGUYEN NANCY Y N T/ROSIE T/NGA	7150 ROTELLA	1878	1440.80
03800510520000	ALI M KHADIM IRREVOCABLE TRUST	7140 ROTELLA	2105	1570.75
03800510530000	BUI JESSICA	7100 ROTELLA	1601	1228.29
03800510540000	THONG QUAY A	7090 ROTELLA	1878	1401.36
03800510550000	PHONCHANTHASONE SOUKANE	7080 ROTELLA	1956	1478.74
03800510560000	AHMED FATUMA H/SAID YIMER	7070 ROTELLA	1956	1478.74
03800510570000	NGU WA/MI L	7069 ROTELLA	1503	1136.27
03800510580000	SAECHAO LUANG FINH/IAN CHUE	7079 ROTELLA	1956	1530.77
03800510590000	SAECHAO BOBBY F/LINDA F/TOM L	7091 ROTELLA	1750	1369.55
03800510600000	SAETEUN NAI C/KAO C/KOW ORN	7099 ROTELLA	1878	1401.36
03800530010000	TRUONG SUONG PHAT	7198 ROTELLA	1809	1324.55
03800530020000	PRASAD CHANDKA	7192 ROTELLA	1227	915.59

SACRAMENTO CITY UNIFIED SCHOOL DISTRICT
Community Facilities District No. 2
2019-2020
Special Tax Roll

Assessor Parcel Number	Owner	Site Address	Square ft.	CFD #2 Tax
03800530030000	LE JENNY	7184 ROTELLA	1878	1440.80
03800530040000	WANG NAN	6021 71ST	1503	1136.27
03800530050000	THONG RICKY	6031 71ST	1750	1323.00
03800530060000	LAU AGNES/KENNY TUYEN/MIKE H	6041 71ST	1750	1323.00
03800530070000	ESQUEDA MARIA A	6051 71ST	1503	1136.27
03800530080000	BUI COURTNEY T	7183 GIFT	1879	1409.25
03800530090000	CHENG M DUI REV TRUST	7191 GIFT	1809	1324.55
03800530100000	HUANG SHENG HUA/MEI W LI	7199 GIFT	1795	1314.30
03800540010000	LI AN QI/YING J TAN	7167 ROTELLA	1878	1440.80
03800540020000	HO CHRISTOPHER C/FANNY S	7175 ROTELLA	1878	1440.80
03800540030000	VOONG MACK NHAT	7183 ROTELLA	1878	1440.80
03800540040000	NINH MARY	7191 ROTELLA	1878	1440.80
03800540050000	XIONG YEE/PA HOUA HER	7199 ROTELLA	1878	1375.07
03800540060000	LE LINH	7151 ROTELLA	2105	1570.75
03800540070000	LE NGOC A/MAN A NGU	7159 ROTELLA	2105	1647.37
03800550020000	LAY SOI CHI	7198 GIFT	1601	1172.25
03800550030000	LEE THAI/YER MOUA	7192 GIFT	1466	1073.41
03800550040000	TRAN SAM	7184 GIFT	1466	1073.41
03800550050000	LEE CHRISTOPHER CHENG/YANG	7176 GIFT	1207	900.66
03800550060000	CHEN BANGWEN	7168 GIFT	1202	880.10
03800550070000	LUC TRUNG HUY	7201 LEMON HILL	2105	1591.38
03800550080000	SAETERN LO SIEW/FAM V	7305 LEMON HILL	2105	1591.38
03800550090000	YE SUKI LIANG	6080 BELLEVIEW	2105	1591.38
03800550100000	WONG CARISSA	6090 BELLEVIEW	1750	1323.00
03800550110000	YULAN XU/CAI F LUONG	6091 71ST	1956	1530.77
03800550120000	HUANG FU	6081 71ST	2105	1647.37
03800550130000	ANDREW HUYNH REVOCABLE	6071 71ST	2105	1647.37
03800550140000	NGUY MARVIN V/ROSE VO	6061 71ST	1750	1369.55
03801110480000	PHILLIP N CHANG LIVING TRUST	6870 LEMON HILL	1800	1343.16
03801110490000	SU JASON/JOEY	6880 LEMON HILL	2222	1688.94
03801110500000	ASHOK MANJULA W	5 BRYCE	1655	1184.15
03801110520000	RAND FAMILY TRUST	6 BRYCE	2200	1672.22
03801110530000	MEHMI SANTOKH/NARESH PAL	6160 FRANCINE	1545	1230.44
03801110540000	TANG PAUL PHON A	6166 FRANCINE	1545	1230.44
03801110550000	TANG PAUL P A/PAUL P A	6172 FRANCINE	1545	1289.92
03801110560000	TANG PAUL PHON A	6178 FRANCINE	1545	1289.92
03801110570000	LEE ANDY T	6179 FRANCINE	1545	1230.44
03801110580000	TANG PAUL PHON A	6173 FRANCINE	1545	1230.44
03801110590000	TANG PAUL PHON A	6167 FRANCINE	1545	1230.44
03801110600000	TANG PAUL PHON A	6161 FRANCINE	1545	1228.28
03801210520000	LEE ROMON/IRENE	6101 LEMON BELL	2000	1584.00
03801210530000	HUYNH TOM/NHUNG TRAN	6107 LEMON BELL	2000	1584.00

SACRAMENTO CITY UNIFIED SCHOOL DISTRICT
Community Facilities District No. 2
2019-2020
Special Tax Roll

Assessor Parcel Number	Owner	Site Address	Square ft.	CFD #2 Tax
03801210540000	VASQUEZ ROSA	6111 LEMON BELL	2171	1719.43
03801210550000	PHAN LINDA K	6117 LEMON BELL	1960	1481.76
03801210560000	GIANG LUONG/KATHERYN CHINH	6121 LEMON BELL	2171	1641.28
03801210570000	TSAN DAN	6125 LEMON BELL	2171	1719.43
03801210580000	AU SANDRA B/ERIC T L CHAN	6129 LEMON BELL	2000	1584.00
03801210590000	ZHEN PANG SHI	6133 LEMON BELL	2000	1584.00
03801210600000	LUONG REVOCABLE LIVING TRUST	6137 LEMON BELL	1516	1200.67
03801210610000	HOANG SU D/WEI M XU	6141 LEMON BELL	1645	1302.84
03801210620000	KHAN TASNEEM	6145 LEMON BELL	2171	1719.43
03801210630000	AMANDA HOMES INC	6149 LEMON BELL	2000	1584.00
03801210640000	FENG GUANG ZI	6153 LEMON BELL	2171	1719.43
03801210650000	NGUYEN DIEN VAN	6157 LEMON BELL	2171	1719.43
03801210660000	LY ALBERT/MAY	6161 LEMON BELL	2000	1584.00
03801210670000	LO MICHAEL/MI	6165 LEMON BELL	2000	1520.20
03801210680000	LY ANH B/HOA THE	6169 LEMON BELL	2171	1719.43
03801210690000	HUYNH SIMON T/SUSAN LUU	6173 LEMON BELL	2000	1584.00
03801210700000	HANSON JULIE K	6177 LEMON BELL	2171	1719.43
03801210710000	MAI VINCE	6181 LEMON BELL	1960	1552.32
03801210720000	CHAN MINDY M/JIMMY	6185 LEMON BELL	2000	1584.00
03801210730000	FENG YAN XIU	6189 LEMON BELL	2171	1719.43
03801210740000	LAM CHI H/KHANH H	6193 LEMON BELL	2000	1584.00
03801210750000	HUYEN TRAN REVOCABLE TRUST	6197 LEMON BELL	2171	1719.43
03801210760000	MEDINA SERGIO V	6196 LEMON BELL	2171	1719.43
03801210770000	WANG BO	6192 LEMON BELL	1960	1481.76
03801210780000	MONG QUAN C/HANLEE	6188 LEMON BELL	1960	1481.76
03801210790000	HUYNH VIVIAN	6184 LEMON BELL	1960	1481.76
03801210800000	LEE TRUST	6180 REALI	2000	1584.00
03801210810000	DING PINGPING	6176 REALI	2000	1584.00
03801220010000	REYES-ANGELES JUAN M/RINA	6168 LEMON BELL	2000	1584.00
03801220020000	NEWMAN RON/NGOC NGA THI DO	6164 LEMON BELL	2171	1719.43
03801220030000	VONG VAN/VIVIAN HONG	6160 LEMON BELL	2171	1641.28
03801220040000	ESTEBAN CHOY	6156 LEMON BELL	1960	1481.76
03801220050000	YU JIANMING	6152 LEMON BELL	2172	1642.03
03801220060000	SAECHAO CHOYORN/NAI C SAELEE	6144 LEMON BELL	1960	1552.32
03801220070000	LE AMIE	6136 LEMON BELL	2171	1719.43
03801220080000	VO CHRYSYNE T	6128 LEMON BELL	2171	1719.43
03801220090000	SAEPHAN CHENG K/MEY S	6120 LEMON BELL	1960	1481.76
03801220100000	WU PETER C/JULIE LAM	6110 LEMON BELL	2171	1719.43
03801220110000	HUYNH DUYEN KIM/SANG TRUNG	6106 LEMON BELL	2000	1584.00
03801220120000	LEE THAI/YER MOUA	6100 LEMON BELL	1960	1481.76
03801220130000	MHL INVS INCORPORATED	7320 LEMON HILL	0	0.00
04002500530000	THAO CHEE	6245 FOWLER	1200	878.64

SACRAMENTO CITY UNIFIED SCHOOL DISTRICT
Community Facilities District No. 2
2019-2020
Special Tax Roll

Assessor Parcel Number	Owner	Site Address	Square ft.	CFD #2 Tax
04002500540000	SAETUENE LAI LEE	6247 FOWLER	1200	878.64
04002500550000	SAETEUNE KIAM FOU	6249 FOWLER	1200	878.64
04002500560000	LUONG JOHNNY T/JESSICA PHONG	6251 FOWLER	1200	878.64
04002700010000	HIN MUI P	7380 ELDER CREEK	2234	1635.73
04002700020000	SINGH ASHISH/ASHIKA	7390 ELDER CREEK	2234	1635.73
04002700030000	SINGH GURCHAMAN	6400 COUGAR	2234	1635.73
04002700040000	SAELEE FAHM C/WEUN TINH LEE	6406 COUGAR	1889	1383.13
04002700050000	NGUYEN PHAT	6412 COUGAR	1889	1383.13
04002700060000	SAEVANG KAO/CHIO HIN	6418 COUGAR	2234	1635.73
04002700070000	DUI DINH A	7391 KRISHNA	1446	1058.76
04002700080000	DU MARY CHUN/SAM SHU/SEAN CHI	7381 KRISHNA	1547	1132.71
04002700090000	LEE RONNIE W	7371 KRISHNA	1889	1383.13
04002700100000	SAETEURN JIAM YOUN/MAN ORN	7370 KRISHNA	2234	1713.92
04002700110000	CACH PHAN A	7380 KRISHNA	2234	1635.73
04002700120000	PHON QUANG/HUNG/XAI	7390 KRISHNA	1889	1383.13
04002700130000	DIEU THIEU V	6450 COUGAR	2234	1635.73
04002700140000	LEW LISA	6456 COUGAR	1889	1383.13
04002700150000	PRAKASH SASHI/RAVENDRA	6462 COUGAR	1889	1383.13
04002700160000	SAECHAO MEUY	6468 COUGAR	2234	1635.73
04002700170000	VOONG KHIENG S	7381 RADHA	1889	1383.13
04002700180000	KUMAR RATNESH	7371 RADHA	2234	1635.73
04002700190000	LIN CHRIS CHU JIE	7361 RADHA	2234	1713.92
04002700200000	CHANDRA KAMAL	7360 RADHA	1547	1132.71
04002700210000	SAECHAO RICKY KAO/SENG POO	7370 RADHA	2234	1635.73
04002700220000	TERN CHUN YONG/CHAN TING	7380 RADHA	1889	1383.13
04002700230000	SAETERN CHAN L/MAY C SAETEURN	7390 RADHA	2234	1635.73
04002700240000	DUONG HAI V/SANG VAN	7398 RADHA	2234	1635.73
04100430110000	VO TUAN V/LOAN K	2751 HING	1222	850.51
04100430120000	VO HUNG V/HANG T M	2761 HING	1222	850.51
04100430130000	VO LAI VAN/LAN/TUAN/DAN THI	2771 HING	1571	1093.42
04100430140000	LEELA SINGH TRUST	6866 CARNATION	1260	876.96
04100430150000	KWONG NORRA	6870 CARNATION	1260	876.96
04100440170000	LALA BHAG C/RATTAN K CHANDRA	2790 HING	1373	982.38
04100440180000	SOLORIO ESTHER RAMOS	2780 HING	1425	1019.59
04100440190000	TANG LENA L/SAMUEL	2770 HING	1940	1388.07
04100440200000	DOMINIC FAMILY TRUST	2760 HING	1222	874.34
04100440210000	LE DAY T/SIA V TIEU	2750 HING	1222	874.34
04100630240000	DANDRIDGE FAMILY TRUST	7001 27TH	1910	773.17
04100630260000	HERNANDEZ OCTAVIANO	2724 57TH	1144	818.53
04100650050000	ROY/LAI PING TJEN-A-LOOI	7009 CARNATION	1203	860.75
04100650060000	SINGH CHANDAR D/SARLA D	7005 CARNATION	1203	860.75
04100650090000	HUTCHINS RANDY LEE/PATRICIA H	6901 CAL VALLEY	1433	1025.31

SACRAMENTO CITY UNIFIED SCHOOL DISTRICT
Community Facilities District No. 2
2019-2020
Special Tax Roll

Assessor Parcel Number	Owner	Site Address	Square ft.	CFD #2 Tax
04100650110000	MA LI CHAO	7016 CANYON TREE	1432	1024.60
04100650120000	CEN JIN RUI/YUE XIAN MA	7012 CANYON TREE	1432	1042.50
04100650130000	YU GUANHUA	7008 CANYON TREE	1432	1042.50
04100650140000	HUANG QI PING	7002 CANYON TREE	1847	1321.53
04100650150000	LAMBA NIPPY S	7000 CANYON TREE	1847	1321.53
04100660140000	SPANN CARL/FRANCIS S	2851 LOCK	2234	1598.43
04100660150000	PHAN LINDA K	2861 LOCK	2234	1598.43
04100660160000	CHU DENNIS A/LINDA N	2871 LOCK	2234	1598.43
04100660170000	CAKAU LINDA/ALIPATE M	7050 INDIAN	2234	1598.43
04100660180000	MCCLAIN RHEBA	7046 INDIAN	2234	1598.43
04100660190000	VUE CHAI/GERRI C YANG	7042 INDIAN	2234	1598.43
04100660200000	YANG CHOU P/BEE V	7038 INDIAN	1847	1321.53
04100660210000	VANG GRACE	7034 INDIAN	2234	1598.43
04100660220000	2018 3 IH BORROWER LP	7030 INDIAN	2234	1598.43
04100660230000	CAI DIANA/JIM	2858 YREKA	1847	1321.53
04100660240000	TRAN-PHAM 2018 FAMILY TRUST	2854 YREKA	2234	1598.43
04100660250000	KUMAR SATISH/KAMLESH	2850 YREKA	2234	1626.35
04100660260000	PHAN LINDA K	2826 YREKA	2234	1598.43
04100670010000	AU DAVID/ERICA LUC	7001 CANYON TREE	1847	1321.53
04100670020000	LEE BLONG/BLIA YANG	7005 CANYON TREE	1847	1321.53
04100670030000	ELAINE KWONG LIVING TRUST	7009 CANYON TREE	1432	1024.60
04100670040000	CHIN GIM O	7013 CANYON TREE	1500	1073.25
04100670050000	HUANG JIAN Q/HAOHAO	7017 CANYON TREE	1847	1321.53
04100670060000	LI YAO YUAN/MU ZHEN	7021 CANYON TREE	2234	1598.43
04100730180000	NAND AVIKASH/KAVITA	2500 LOCK	1750	1386.00
04100730190000	SAETERN LIEW YAO/SEN YAO	2510 LOCK	1749	1280.62
04100730200000	BERTALAN HERMAN LIVING TRUST	7111 25TH	1570	1149.55
04100730210000	PRASAD JAGDISH	2520 LOCK	1785	1306.98
04100730220000	SINGH NEELAM/RONESH/SURAN	2530 LOCK	1785	1306.98
04100730230000	SAEYANG BOUNCHONG	2540 LOCK	1785	1306.98
04100760010000	LI FUZHOU	2501 LOCK	1750	1386.00
04100760020000	LEE JIN WANG/JIN WANG	2511 LOCK	1749	1280.62
04100760030000	HER SHIRLEY/BEE XIONG	7051 25TH	1385	1014.10
04100760040000	PRAKASH ASHISH/SHIRI D	2521 LOCK	1785	1306.98
04100760050000	WATI DREMILA/SUBHAS CHAND	2531 LOCK	1785	1306.98
04100760060000	VUE SO	2541 LOCK	1785	1306.98
04100760070000	THAO MAI Y/CHA VANG/MARLEI	2551 LOCK	1785	1306.98
04100760080000	JU JULIE K/DONALD S/KAM P	2561 LOCK	1785	1306.98
04700130110000	CITY OF SACRAMENTO	7290 24TH	0	0.00
04802600350000	CITY OF SACRAMENTO	CASA LINDA	0	0.00
04802700010000	AYANA GEMECHU K/DESSIFTU T	7711 ADDISON	2506	1992.27
04802700020000	LEE ZJAY C/PAM M	7719 ADDISON	2189	1740.26

SACRAMENTO CITY UNIFIED SCHOOL DISTRICT
Community Facilities District No. 2
2019-2020
Special Tax Roll

Assessor Parcel Number	Owner	Site Address	Square ft.	CFD #2 Tax
04802700030000	TINH DINH REVOCABLE TRUST	7725 ADDISON	2506	1992.27
04802700040000	SOTELO ALVIN R	7731 ADDISON	1695	1347.53
04802700050000	CARIDAD ALVIN	7737 ADDISON	2289	1819.76
04802700060000	LEE LEE P/LY SHOU V XONGCHAO	7743 ADDISON	2506	1992.27
04802700080000	ROBINSON	7744 ADDISON	1695	1347.53
04802700090000	AGDIGOS MARYBEL F/ROLANDO G	7738 ADDISON	2506	1992.27
04802700100000	RAJ RADHIKA DEV/SURAJ BHAN	7732 ADDISON	1695	1347.53
04802700110000	KUANG WAYNE/SUE YU	7720 ADDISON	2189	1740.26
04802700120000	YU TING HUO/YU QUANG KUANG	7714 ADDISON	2506	1992.27
04802700130000	AHMAD FAIZAN/USMAN	7708 ADDISON	1695	1347.53
04802700140000	VUE VANG CHIA	7702 ADDISON	2289	1819.76
04802700150000	YU HIU L/STEVEN HARRIS	7692 ADDISON	1695	1347.53
04802700160000	PORTACIO ANGELE	7690 ADDISON	2506	1992.27
04802700170000	WANG-CHAO CHUN TRUST	7684 ADDISON	1504	1195.68
04802700180000	SARELLANO CESAR H/ELIZABETH	7678 ADDISON	2289	1819.76
04802700190000	YEE KEN HAN	7672 ADDISON	2506	1992.27
04802700200000	SY JANIE	7666 ADDISON	2289	1819.76
04802700210000	PRASAD ROVILA	7660 ADDISON	1695	1347.53
04802700220000	KANYAVONG SICHAN/KANYAVONG	7654 ADDISON	2189	1740.26
04802700230000	HUANG WILLIAM/TRACY Z	7648 ADDISON	2289	1819.76
04802700240000	KHABRA HARIQBAL/KAMALJIT	7642 ADDISON	2506	1992.27
04802700250000	MARTIN AKIMA	7636 ADDISON	1504	1195.68
04802700260000	SIDHU MANPREET/GULPREET	7630 ADDISON	2289	1819.76
04802700270000	MASSEY MARIA A	7621 ADDISON	2506	1992.27
04802700280000	ALI SAHEEN/SHAZMEEN	7615 ADDISON	2506	1992.27
04802700290000	SEABERG SHIELA L	7607 ADDISON	1504	1195.68
04802700300000	HANG PHUNG M/THUAN M	7601 ADDISON	2289	1819.76
04802700310000	VANG SHOUA/MO CHA	2250 CASA LINDA	2506	1992.27
04802700320000	PUNGAN RACHEL TAGATAC	2240 CASA LINDA	2289	1819.76
04802700330000	LOR TOUA/KHOVA	2230 CASA LINDA	1504	1195.68
04802700340000	DIMEL UGOCHUKWU G	2220 CASA LINDA	2289	1819.76
04802700350000	CUDJOE EKOW YARTEL/THERESE A	7543 MUIRFIELD	1695	1347.53
04802700360000	ORTEGA CECILIA/RAFAEL O	7548 MUIRFIELD	2289	1819.76
04802700370000	CHAND ROHINI/ADWIN	7544 MUIRFIELD	1695	1347.53
04802700380000	2018 3 IH BORROWER LP	7540 MUIRFIELD	2506	1992.27
04802700390000	ROSS TONIA	7536 MUIRFIELD	1695	1347.53
04802700400000	KEOPANYA KHAMSAVAT	7532 MUIRFIELD	2289	1819.76
04802700410000	NGUYEN THY M	7528 MUIRFIELD	1695	1347.53
04802700420000	LEE JUDITH/KOU	7524 MUIRFIELD	2506	1992.27
04802700430000	CHANG ASHLEY CHING	7520 MUIRFIELD	2289	1819.76
04802700440000	JONES ERIC A/ERICKA	7521 MUIRFIELD	1695	1347.53
04802700450000	VANG TOU H	7525 MUIRFIELD	1504	1195.68

SACRAMENTO CITY UNIFIED SCHOOL DISTRICT
Community Facilities District No. 2
2019-2020
Special Tax Roll

Assessor Parcel Number	Owner	Site Address	Square ft.	CFD #2 Tax
04802700460000	XIE ETHAN Z	7529 MUIRFIELD	2289	1819.76
04802700470000	LESTER R/MARTHA L MCQUILLON	7533 MUIRFIELD	1695	1347.53
04802700480000	SHARMA NITESH/VIKASHNI	7537 MUIRFIELD	2506	1992.27
04802700490000	STERNAGLE DAVID P/MARILYN	7541 MUIRFIELD	1695	1347.53
04802700500000	XIONG KAYING/VA CHANG/SOUA	2221 CASA LINDA	2506	1992.27
04802700510000	LUONG DUNG/THU H TRAN	2231 CASA LINDA	1695	1347.53
04802700520000	SAECHAO CHENG JOY/NAI FONG	2241 CASA LINDA	2289	1819.76
04802700530000	DIGGS ADRIANE	2251 CASA LINDA	1695	1347.53
04802700540000	VANG MAI Y/SUE YANG	7564 ADDISON	2506	1992.27
04802700550000	BAUTISTA LILIA M/VICTOR M	7558 ADDISON	1504	1195.68
04802700560000	XABANDITH CONNIE	7552 ADDISON	2289	1819.76
04802700570000	RAY REBECCA/REBECCA RAY	7546 ADDISON	1695	1347.53
04802700580000	YANG LINDA	7540 ADDISON	2506	1992.27
04802700590000	GENG YAN L	7537 ADDISON	1695	1347.53
04802700600000	CITY OF SACRAMENTO	MEADOWVIEW	0	0.00
04802700610000	CITY OF SACRAMENTO	MEADOWVIEW	0	0.00
04802700620000	CITY OF SACRAMENTO	ADDISON	0	0.00
04802700630000	CITY OF SACRAMENTO	ADDISON	0	0.00
04900500220000	SACRAMENTO REGIONAL TRANSIT	MEADOWVIEW	0	0.00
04900710020000	SACRAMENTO REGIONAL TRANSIT	MEADOWVIEW	0	0.00
04905700010000	BUZZ OATES LLC/BUZZ OATES	7543 WAINSCOTT	0	0.00
04905700020000	BUZZ OATES LLC/BUZZ OATES	7555 WAINSCOTT	0	0.00
04905700030000	BUZZ OATES LLC/BUZZ OATES	3251 ELLWOOD	0	0.00
04905700040000	BUZZ OATES LLC/BUZZ OATES	7595 WAINSCOTT	0	0.00
04905700050000	BUZZ OATES LLC/BUZZ OATES	3230 ELLWOOD	0	0.00
04905700060000	BUZZ OATES LLC/BUZZ OATES	3231 ELLWOOD	0	0.00
04905700070000	CITY OF SACRAMENTO	7540 WAINSCOTT	0	0.00
04905800020000	DHANOTA FAMILY REVOCABLE	26 LOMA VERDE	1686	0.00
04905800030000	JACKSON CAROLYN LORRAINE	20 LOMA VERDE	1395	0.00
04905800040000	MALISHUK VICTOR	14 LOMA VERDE	1395	1146.27
04905800050000	SINGH JATINDER/RAJNI	8 LOMA VERDE	1395	1146.27
04905800060000	WATSON WALTER E	2 LOMA VERDE	1395	1146.27
04905800070000	SHARMA NEERAJ/PRIYANKA	3212 LOMA VERDE	1395	1201.51
04905800080000	LANIGAN BELLZORA/PARTRENIA	3206 LOMA VERDE	1395	1170.68
04905800090000	BRADFORD CALIPH JR	7516 HITHER	1395	1258.01
04905800100000	ABAYA MARIBES	7512 HITHER	1258	1083.52
04905800110000	HERNANDEZ JOSE LUIS SOUSA	7508 HITHER	1033	889.72
04905800120000	JAMES TIFFANY	7504 HITHER	1258	1083.52
04905800130000	GONZALEZ ANTONIA/SALVADOR	7500 HITHER	1395	1201.51
04905800140000	KOROI SENILOLI/SHOBHNA PRASAD	7496 HITHER	1258	1083.52
04905800150000	YOUNG LINA B/MICHELLE C	7492 HITHER	1686	1452.15
04905800160000	NGUYEN GIANG N/HUNG V TRUONG	7486 HITHER	1280	1131.65

SACRAMENTO CITY UNIFIED SCHOOL DISTRICT
Community Facilities District No. 2
2019-2020
Special Tax Roll

Assessor Parcel Number	Owner	Site Address	Square ft.	CFD #2 Tax
04905800170000	SURIGAO WYCLIFFE	7480 HITHER	1258	1083.52
04905800180000	SMITH KATHY ROSE	7474 HITHER	1395	1258.01
04905800190000	YEUNG ENOCH/PRISCILLA	3215 WATER MILL	2247	0.00
04905800200000	GUTIERREZ ELENA/ELENA ANGEL	3221 WATER MILL	2962	0.00
04905800220000	ROBERT/ELISA PEREZ JR FAMILY	3233 WATER MILL	2562	0.00
04905800230000	YUAN 2009 TRUST	3239 WATER MILL	2203	0.00
04905800240000	NYONG ODISA	3245 WATER MILL	2247	1959.38
04905800250000	IP CHOK YAN	3251 WATER MILL	1686	0.00
04905800260000	JACOBS ANTHONY L	3257 WATER MILL	2203	1921.02
04905800270000	YU PUI HA	3263 WATER MILL	2036	0.00
04905800280000	BRITTON JALEESA D	3269 WATER MILL	1686	1385.39
04905800290000	HE JIAN JUN/MEI HONG LIANG	3275 WATER MILL	1686	1520.43
04905800300000	ZENG ZHI F	3281 WATER MILL	2036	1836.06
04905800310000	AGUILAR EMMA G/GERARDO A	3287 WATER MILL	1686	1520.43
04905800320000	DIXON KAMALA K	3293 WATER MILL	1033	889.72
04905800330000	ENCARNACION RIC B	7477 GEORGICA	1258	1106.03
04905800340000	KUMAR ASHEENAL/ARTI S	7479 GEORGICA	1258	1106.03
04905800350000	SITU CHUNHUA/HAIWEI JIANG	7481 GEORGICA	1033	908.21
04905800360000	WANG WEIBO/XUJUAN XIONG	7485 GEORGICA	1258	1106.03
04905800370000	TRAN ANDREA	7487 GEORGICA	1686	1482.33
04905800380000	HE XIUPING/CHAOWEN JIANG	7489 GEORGICA	2036	1790.05
04905800390000	RAMOS ADAN A/GEORGINA AMADOR	7491 GEORGICA	1686	1482.33
04905800400000	BAILEY PATRICIA A	7493 GEORGICA	1258	1106.03
04905800410000	TAVITAS RODNEY A	7495 GEORGICA	1686	1482.33
04905800420000	ABIMBOLA OLUWAPELUMI O	7501 GEORGICA	1258	1106.03
04905800430000	NAND FAMILY TRUST	7503 GEORGICA	1033	866.89
04905800440000	FELICES JOVELYN	7505 GEORGICA	1228	1030.54
04905800450000	DESILVA SURANGANIE J	7507 GEORGICA	1686	1414.89
04905800460000	KHAN NADEEM I	7509 GEORGICA	1258	1055.71
04905800470000	ROGERS DANNIE E	7511 GEORGICA	2036	1836.06
04905800480000	WILSON MEGAN	7515 GEORGICA	1258	1055.71
04905800490000	BARAJAS REGINO	7517 GEORGICA	1686	1520.43
04905800500000	NARAIN CHANDRA K/PADUM LATA	7519 GEORGICA	1258	1055.71
04905800510000	MOUA YOUA/JASON XIONG	7521 GEORGICA	1686	1520.43
04905800520000	SHARMA VIKASH/RADHIKA RAI	7523 GEORGICA	2036	1836.06
04905800530000	INGRAM STEVEN D/TANAIRI	7525 GEORGICA	1686	1520.43
04905800540000	CALVILLO VERONICA J	7527 GEORGICA	1258	1134.46
04905800550000	TUPAZ DIPIKA K/RONALD	7529 GEORGICA	1686	1520.43
04905800560000	MOORE SHAWN	7533 GEORGICA	1258	1083.52
04905800570000	DACLAN TRINH T/JOHN	7530 GEORGICA	1693	1633.41
04905800580000	BEJAR RAMCHAND S/PAULINE C	7528 GEORGICA	1258	1055.71
04905800590000	YEAGER CARL L/DALILA PITTA	7526 GEORGICA	1686	1520.43

SACRAMENTO CITY UNIFIED SCHOOL DISTRICT
Community Facilities District No. 2
2019-2020
Special Tax Roll

Assessor Parcel Number	Owner	Site Address	Square ft.	CFD #2 Tax
04905800600000	NGO DAVID	7524 GEORGICA	2036	1836.06
04905800610000	AGRAWAL PRAMOD	7522 GEORGICA	1258	1055.71
04905800620000	DEA MAN Y	7520 GEORGICA	1279	1124.50
04905800630000	SCOGNAMIGLIO JOSEPH J	7518 GEORGICA	1258	1106.03
04905800640000	PRASAD RISHI/KAVITA	7516 GEORGICA	1258	1106.03
04905800650000	PRASAD KIRTESH	7512 GEORGICA	2036	1708.61
04905800660000	CALDERON MARISA J	7510 GEORGICA	1258	1055.71
04905800670000	ROY MICHELLE S	7508 GEORGICA	1033	866.89
04905800680000	SAVAGE TAMISHA	7504 GEORGICA	1686	1414.89
04905800690000	SINGH DEVESHNI	7502 GEORGICA	2036	1708.61
04905800700000	CHA KAO	7500 GEORGICA	1258	1055.71
04905800710000	GANT EFFIE B	7496 GEORGICA	1033	866.89
04905800720000	SAECHAO LENA K	7492 GEORGICA	1686	1414.89
04905800730000	DEO SURUJ	7488 GEORGICA	1258	1055.71
04905800740000	PRASAD SATISH/SONIL	7484 GEORGICA	2036	1708.61
04905800750000	TRAN VIEN U	7483 WAINSCOTT	1258	1055.71
04905800760000	PELLERIN CARMEN M	7487 WAINSCOTT	1033	866.89
04905800770000	WILLIAMS DARNELL	7491 WAINSCOTT	1258	1055.71
04905800780000	REGINALD/CHARLENE BENNETT	7495 WAINSCOTT	1686	1414.89
04905800790000	RAJESH KUMAR TRUST	7501 WAINSCOTT	1258	1106.03
04905800800000	VELASQUEZ RIYADH G/DENVER G	7503 WAINSCOTT	1258	1106.03
04905800810000	CHO KOOK	7505 WAINSCOTT	1033	908.21
04905800820000	TRAN TINA/CHANNARA SARIN	7507 WAINSCOTT	1258	1106.03
04905800830000	JIANG QI B	7509 WAINSCOTT	1686	1482.33
04905800840000	LY HUYEN T	7511 WAINSCOTT	1258	1134.46
04905800850000	JACKSON NASHEA	7515 WAINSCOTT	1033	889.72
04905800860000	PAGE SCHITARA VICTORIA	7517 WAINSCOTT	1258	1106.03
04905800870000	GOUNDAN MUNI N/YASHODA DEVI	7519 WAINSCOTT	1686	1482.33
04905800880000	GROSS DARIES D/KATHY SMITH	7521 WAINSCOTT	2562	2131.58
04905800890000	SHEN ZHI JIANG	7523 WAINSCOTT	2010	1672.32
04905800900000	CHUNG STANLEY/CHUNG FAMILY	7525 WAINSCOTT	1849	1538.37
04905800910000	LE NAM THAI/NGUYET QUE L TRAN	7527 WAINSCOTT	1686	1402.75
04905800920000	CALDERON EDILBERTO C/IRENE C	7529 WAINSCOTT	1033	848.82
04905800930000	CITY OF SACRAMENTO	7501 HITHER	0	0.00
04905800940000	CITY OF SACRAMENTO	38 LOMA VERDE	0	0.00
04905900030000	SINGH PARVIN/SHAREEN S KUAR	7384 TISDALE	2036	1874.75
04905900040000	LIU XIUJIAN	7388 TISDALE	1258	1158.37
04905900050000	ANAND PREETIKA/NILKANT N LAL	7392 TISDALE	2036	1874.75
04905900060000	ANITA K SINGH 2015 REVOCABLE	7396 TISDALE	1033	951.19
04905900070000	TRAN VUI V/LOAN T	7400 TISDALE	1258	1158.37
04905900080000	NEELY LEONARD/TIFFANI GRIMES	7404 TISDALE	1693	1558.91
04905900090000	MCKENZIE IRIS M	7408 TISDALE	1033	951.19

SACRAMENTO CITY UNIFIED SCHOOL DISTRICT
Community Facilities District No. 2
2019-2020
Special Tax Roll

Assessor Parcel Number	Owner	Site Address	Square ft.	CFD #2 Tax
04905900100000	LUM FRANKLIN	7412 TISDALE	1693	1558.91
04905900110000	KISHORE SHALVIN SURESH/SHOMAL	7416 TISDALE	2036	1874.75
04905900120000	KAUR SATWINDER/RAM LAKHBIR	7420 TISDALE	1258	1158.37
04905900130000	CAYABYAB JEFFREY R/JUDY Z	7424 TISDALE	1033	951.19
04905900140000	BANNERMAN JOSEPHINE Y/ALFRED	7428 TISDALE	1693	1558.91
04905900150000	FELDER DANIEL/DARLENE E	7432 TISDALE	2036	1874.75
04905900160000	ALI ZOHEB/ALI FARINA	7436 TISDALE	1258	1158.37
04905900170000	NGUYEN LOC V	7440 TISDALE	1693	1558.91
04905900180000	REYNALDO V GASPAR LIVING	7444 TISDALE	1033	951.19
04905900190000	HER CHU/MICHAEL L WILLIAMS	7448 TISDALE	1258	1158.37
04905900200000	DUFFEY RACHEL/DUFFEY PETE	7452 TISDALE	1693	1558.91
04905900210000	NARESH RAM/USHA	7456 TISDALE	2036	1874.75
04905900220000	CHANG ELIZABETH/ZANG THAO	7460 TISDALE	1258	1158.37
04905900230000	PITTMON MABEL	7464 TISDALE	1033	951.19
04905900240000	SHARMA	7468 TISDALE	1258	1158.37
04905900250000	ALI SAIYAZ/NISHA SONAL	7472 TISDALE	1686	1552.47
04905900260000	SANTOS SCHWEND E/SANTOS LEAH	7476 TISDALE	2036	1874.75
04905900280000	WRIGHT TERESA	7443 GEORGICA	1618	1489.85
04905900290000	SIMMANO MALYCHANH	7447 GEORGICA	1693	1558.91
04905900300000	HANIF MOHAMMED S/YASHMIN N ALI	7451 GEORGICA	1258	1158.37
04905900310000	LEDWARD LAKISHA	7479 TISDALE	1033	951.19
04905900320000	THOMPSON TARA L	7475 TISDALE	1258	1158.37
04905900330000	YANG JACKSON	7471 TISDALE	2036	1874.75
04905900340000	CHIEM HELEN T M/VINH V VO	7467 TISDALE	1258	1158.37
04905900350000	SAGAR ALKABEN R/KAUSHAL R	7463 TISDALE	1686	1552.47
04905900360000	SAELEE JENNY	7459 TISDALE	2036	1874.75
04905900370000	LIE GUOGEN/YANHUA ZHANG	7455 TISDALE	1258	1158.37
04905900380000	LIN CHUNMEI/HAILONG	7451 TISDALE	1693	1558.91
04905900390000	CELESTINE ROSELLA C	7447 TISDALE	2036	1874.75
04905900400000	PERUMAL PETHURAJ/PETHURAJ	7443 TISDALE	1693	1558.91
04905900410000	VO TRISH	7453 HITHER	1033	996.64
04905900420000	MENDOZA JORGE R/MARIA G	7457 HITHER	1693	1633.41
04905900430000	LIU DANDAN	7461 HITHER	1258	1213.72
04905900440000	HUSARY GRACE R/NAHED F	7465 HITHER	2036	1964.33
04905900450000	VONG ZHENGCHANG/LAM H DAM	7469 HITHER	1033	996.64
04905900460000	URIBE JULIA	7470 HITHER	2036	1964.33
04905900470000	KO CHIH/ZHUOQI S	7466 HITHER	1258	1213.72
04905900480000	CHEUNG JACSICA	7462 HITHER	2036	1964.33
04905900490000	CHAN CATHERINE	7458 HITHER	1258	1158.37
04905900500000	MURRAY MARK J/MIRANDA J	7454 HITHER	1033	951.19
04905900510000	JIA XIAODONG	7405 TISDALE	2036	1874.75
04905900520000	PANCHAL DIGESH	7401 TISDALE	1693	1558.91

SACRAMENTO CITY UNIFIED SCHOOL DISTRICT
Community Facilities District No. 2
2019-2020
Special Tax Roll

Assessor Parcel Number	Owner	Site Address	Square ft.	CFD #2 Tax
04905900530000	CONTRERAS PEDRO/PEDRO	7397 TISDALE	1258	1158.37
04905900540000	GRIFFITH MARK	7393 TISDALE	1033	951.19
04905900550000	SHAIKH MOHAMMED FAHED/FAIZAN	7389 TISDALE	2036	1874.75
04905900560000	DORADO JOSE M/YENY L	7385 TISDALE	1693	1558.91
04905900570000	WANG JIAN	7381 TISDALE	2036	1874.75
04906000010000	GARRETT CHERYL GRACE	7453 GEORGICA	2036	1874.75
04906000020000	JAMILAHA FORREST REV TRUST	7457 GEORGICA	1693	1558.91
04906000030000	LEE ERNEST T JR	7461 GEORGICA	1258	1158.37
04906000040000	ROSE SANDRA	7465 GEORGICA	2036	1874.75
04906000050000	MONTERO ANGELICA/MARTIN R	7469 GEORGICA	1693	1558.91
04906000060000	KARIM SOBIRAN/ROHANI ROHANI	7473 GEORGICA	1033	951.19
04906000070000	TRUONG CAM	3264 TORRANCE	1033	908.21
04906000080000	JAVILLONAR ROGELIO	3260 TORRANCE	1693	1488.49
04906000090000	SANDY DANIEL ABDURAMA/ISATU	3256 TORRANCE	2036	1790.05
04906000100000	HEREDIA JAVIER/CORY L KENNEDY	3252 TORRANCE	1258	1106.03
04906000110000	MAO QUI THUY	3248 TORRANCE	1693	1488.49
04906000120000	LEE YE	3244 TORRANCE	1258	1106.03
04906000130000	EDDINGS GLENN J	3240 TORRANCE	2036	1790.05
04906000140000	COOK JANA E	3236 TORRANCE	1693	1488.49
04906000150000	AGUILAR GALINDO DIANA V	3232 TORRANCE	1258	1106.03
04906000160000	BAO SAN	3228 TORRANCE	2036	1790.05
04906000170000	PRYOR JOSHUA DANIEL/TAYLOR	3224 TORRANCE	1693	1488.49
04906000180000	VONG ZHENGCHANG/HONG	3220 TORRANCE	2036	1790.05
04906000190000	YI WOO Y	3216 TORRANCE	1033	908.21
04906000200000	KUAR SUSHIL J/RAVNESH SINGH	3221 TORRANCE	2036	1874.75
04906000210000	SONI ANUPKUMAR D/HARITA	3225 TORRANCE	1258	1158.37
04906000220000	HE RUI L	3229 TORRANCE	1693	1558.91
04906000230000	SEUTHSANITH YOM/LUIS PINA	3233 TORRANCE	2036	1874.75
04906000240000	DENG SHINUO	3237 TORRANCE	1258	1158.37
04906000250000	WATSON WESLEY JR	3241 TORRANCE	1693	1558.91
04906000260000	MESFIN THEODROS	3245 TORRANCE	2036	1790.05
04906000270000	AQUILIZAN MARIA MONICA E	3249 TORRANCE	1258	1106.03
04906000280000	FUNG MICHAEL W/SUSAN S	3253 TORRANCE	1033	908.21
04906000290000	NJOROGE JANE W/FRANCIS N	3257 TORRANCE	1693	1488.49
04906000300000	REYNOLDS WILLIAM R/CLAUDIO L	3261 TORRANCE	1258	1106.03
05200100910000	CITY OF SACRAMENTO	1900 EXPEDITION	0	0.00
05200100920000	CITY OF SACRAMENTO	1900 EXPEDITION	0	0.00
05200100930000	CITY OF SACRAMENTO	RICHFIELD	0	0.00
05200100940000	CITY OF SACRAMENTO	RICHFIELD	0	0.00
05202100010000	GARCIA ARMANDO	2026 JOHN STILL	2177	1483.62
05202100020000	COOPER MARSHA/WILLIAM	2032 JOHN STILL	2713	2160.63
05202100030000	NGAN HONG/MUI NHI PHO	2038 JOHN STILL	2833	1858.00

SACRAMENTO CITY UNIFIED SCHOOL DISTRICT
Community Facilities District No. 2
2019-2020
Special Tax Roll

Assessor Parcel Number	Owner	Site Address	Square ft.	CFD #2 Tax
05202100040000	SAECHAO NAI	2044 JOHN STILL	2713	2160.63
05202100050000	CHOW JOANNE	2114 JOHN STILL	1404	993.53
05202100060000	JERRANISHA J THOMAS	2120 JOHN STILL	1260	864.12
05202100070000	SANDHU FAMILY TRUST	2126 JOHN STILL	2713	2265.08
05202100090000	SOFIZADA ABDUL/HAFIZA S	2138 JOHN STILL	1777	1483.62
05202100100000	SHARMA RAMESH/SHINKU	2142 JOHN STILL	2177	1415.20
05202100110000	DOBSON ALZETTEA E/MICHELLE M	2146 JOHN STILL	2208	1758.45
05202100120000	BAUTISTA TERESITA NARAG/KAREN	2150 JOHN STILL	2713	2160.63
05202100130000	NARAYAN AMITESH C/HARGIT K	2154 JOHN STILL	3009	2396.37
05202100140000	RIVERA VIOLETA/RENATO F	2158 JOHN STILL	2445	1947.20
05202100150000	SINGH CHANDPRAKAS	2162 JOHN STILL	2713	2160.63
05202100160000	SEEN VUTHY/LISA SOU	2166 JOHN STILL	2333	1858.00
05202100170000	SANCHEZ FELIPE	2170 JOHN STILL	3009	2396.37
05202100180000	CHANDRA HARISH/SASHI	2174 JOHN STILL	2177	1415.20
05202100190000	SY FEN D/CHANG Y ZHONG	2178 JOHN STILL	2713	2160.63
05202100200000	RAMIREZ DIANE	2182 JOHN STILL	2177	1415.20
05202100210000	VANNY THACH REV LIVING TRUST	2186 JOHN STILL	2713	2160.63
05202100220000	SERRATO JUAN C/MARYBEL	2190 JOHN STILL	2713	2160.63
05202100230000	MAYS CHARLES/TERESA DIANE	7723 BETH	1638	1304.50
05202100240000	VUE SIA	2185 JOHN STILL	2190	1433.52
05202100250000	PRASAD BOBBY	2179 JOHN STILL	2833	1858.00
05202100260000	DIMAANO ARBEN R/MA VICTORIA C	2173 JOHN STILL	2713	2160.63
05202100270000	VANG LAURA M/JESSE S XIONG	280 HEMFORD	3009	2396.37
05202100280000	PETRENKO VICTOR/TATYANA	110 HEMFORD	2833	1858.00
05202100290000	HER TOUA/CHANG M VANG	111 HEMFORD	2445	1947.20
05202100300000	LE LINH T	7741 SWEETBRIER	1638	1304.50
05202100310000	FONG KENT	7742 SWEETBRIER	2190	1433.52
05202100320000	KUAR SUSHIL/RAVNESH SINGH	2121 JOHN STILL	1302	1036.91
05202100330000	ZHU FAMILY REVOCABLE TRUST	2111 JOHN STILL	2190	1433.52
05202100340000	HAN DEREK S/VICKY	7758 MANORSIDE	1638	1304.50
05202100350000	2017 1 IH BORROWER LP	2029 BONA VISTA	1302	1036.91
05202100360000	PRASAD LIVING TRUST	7752 MANORSIDE	2190	1433.52
05202100370000	TANG SUIXIANG	7746 MANORSIDE	1638	1304.50
05202100380000	NGUYEN LIEN KIM	7740 MANORSIDE	2190	1433.52
05202100390000	MARKOGLO INNA/ANATOLIY S	7734 MANORSIDE	1638	1304.50
05202100400000	VANG MAO/XEE	7728 MANORSIDE	2190	1433.52
05202100410000	2017 1 IH BORROWER LP	7722 MANORSIDE	1638	1304.50
05202100420000	LI HAI T/LINH N NGUYEN	7716 MANORSIDE	2190	1433.52
05202100430000	GUAN LI J	7708 MANORSIDE	1638	1304.50
05202100440000	CHA YING/NAI S SAEFONG	7707 MANORSIDE	1800	1433.52
05202100450000	TRUONG HUE K/LAI W CHAN	7715 MANORSIDE	1302	1036.91
05202100460000	GEE MAY Y/BING J LIU/ZHI Y	7721 MANORSIDE	2190	1433.52

SACRAMENTO CITY UNIFIED SCHOOL DISTRICT
Community Facilities District No. 2
2019-2020
Special Tax Roll

Assessor Parcel Number	Owner	Site Address	Square ft.	CFD #2 Tax
05202100470000	BACHILLER CATHERINE	7727 MANORSIDE	1638	1304.50
05202100480000	FLORES ROBERTO/MANUEL	7733 MANORSIDE	2190	1433.52
05202100490000	BERRY NINA M	7739 MANORSIDE	1638	1304.50
05202100500000	KOLOAMATANGI VEISINIA/HOPOATE	7745 MANORSIDE	2190	1744.12
05202100510000	HUANG CHUNYING	7736 SWEETBRIER	2190	1433.52
05202100520000	BRAZELTON MAISEO	7730 SWEETBRIER	1638	1304.50
05202100530000	NGHIEM JOHN	7724 SWEETBRIER	2190	1433.52
05202100550000	PRASAD PREM L	7712 SWEETBRIER	2190	1433.52
05202100560000	THAO OLIVIER N/ELODIE A	7706 SWEETBRIER	2190	1433.52
05202100570000	SAGASTUME JOSE O	7705 SWEETBRIER	2190	1433.52
05202100580000	MANUGO BRYAN	7711 SWEETBRIER	1638	1304.50
05202100590000	HUANG SALLY C/MIKE WANG	7717 SWEETBRIER	2190	1433.52
05202100600000	ARNOLD JEFFREY JR	7723 SWEETBRIER	2190	1433.52
05202100610000	PEREZ JOSE F MARTINEZ/DINORA	7729 SWEETBRIER	1302	1036.91
05202100620000	VALLADARES ENRIQUE R/SEIDI J	7735 SWEETBRIER	2190	1433.52
05202100630000	VANG AI	121 HEMFORD	2177	1733.76
05202100640000	DONG DUNG	131 HEMFORD	2833	1858.00
05202100650000	CHANG CHIA/CHAR VUE	141 HEMFORD	2833	1858.00
05202100660000	ALTAMIRA RITA D	151 HEMFORD	2208	1758.45
05202100670000	BORAK ENGINEERING INC	161 HEMFORD	2833	1858.00
05202100680000	HEARN RICK R	171 HEMFORD	2751	2190.90
05202100690000	KUANG WAYNE R	181 HEMFORD	2713	2160.63
05202100700000	FONG LAURA T/MAY K	191 HEMFORD	2177	1415.20
05202100710000	AMANZE DIALA/ODIKIPIRIBIA	201 HEMFORD	2445	1947.20
05202100720000	MENG XINGHUI	211 HEMFORD	2713	2160.63
05202100730000	TABBS JULIUS (EST OF)/MARIE M	221 HEMFORD	2751	2190.90
05202100740000	MARTIN MARY A	231 HEMFORD	2208	1758.45
05202100750000	BAEZ JUAN M	241 HEMFORD	2208	1758.45
05202100760000	FERNANDEZ ARSENIO/AURORA F	251 HEMFORD	2713	2160.63
05202100770000	THOMAS PEREZ PATRICIA/VINCENT	261 HEMFORD	2751	2190.90
05202100780000	GLENDA F HELDRIS REVOCABLE	270 HEMFORD	2445	1947.20
05202100790000	XAYABANHA	260 HEMFORD	3281	2612.99
05202100800000	SAMI SHIROMA D/SABITA D	250 HEMFORD	3281	2612.99
05202100810000	SAETERN SUU/ROXIE SAEVANG	160 HEMFORD	2943	2343.81
05202100820000	YANG CHENG/YIA VANG	150 HEMFORD	2445	1947.20
05202100830000	BHUIE CAMIE	130 HEMFORD	2981	2374.07
05202100840000	SINGH HARBINDER	120 HEMFORD	3653	2612.99
05202100850000	KAM TANG	7718 BETH	1638	1304.50
05202100860000	CASILLAS LETICIA/MARIO	7712 BETH	2527	1712.26
05202100870000	ZHU YAN X/SHU G LIANG	7706 BETH	1638	1304.50
05202100880000	ISLAM NAZBUN NISHA	7700 BETH	2190	1433.52
05202100890000	SAECHAO LAI C	7705 BETH	2190	1433.52

SACRAMENTO CITY UNIFIED SCHOOL DISTRICT
Community Facilities District No. 2
2019-2020
Special Tax Roll

Assessor Parcel Number	Owner	Site Address	Square ft.	CFD #2 Tax
05202100900000	KAZI AZIZ AHMAD/SHUGUFA	7711 BETH	2527	2012.50
05202100910000	CHEN MEIFANG/JUN JIE TAN	7717 BETH	1302	1036.91
05202200010000	FUNG FUNG H/KOK W WU	1910 JOHN STILL	1638	1367.57
05202200020000	RAM ANEETA	1916 JOHN STILL	1302	1087.04
05202200030000	CHAVEZ ANA M	1922 JOHN STILL	2190	1502.82
05202200040000	HABIBVAND JACK	1928 JOHN STILL	1638	1367.57
05202200050000	LI XIAO L/SHAOBIN LIN	1934 JOHN STILL	2190	1502.82
05202200060000	SHARMA JANE/SAURABH	1940 JOHN STILL	1638	1367.57
05202200070000	THR CALIFORNIA LP	1946 JOHN STILL	1302	1087.04
05202200080000	HU FENGYAN/DONGQUAN LAI	1952 JOHN STILL	1638	1367.57
05202200090000	LAURA SHIRLEY REVOCABLE TRUST	1958 JOHN STILL	1712	1363.44
05202200100000	TSANG RICHARD C/PENELOPE L	1964 JOHN STILL	1638	1036.91
05202200110000	GUAN XIAO H/ZHEN Y YU	1970 JOHN STILL	1800	1304.50
05202200120000	CASTER JERDEAN	1976 JOHN STILL	1260	864.12
05202200130000	XIAO JINSHENG/LAN HUANG	1982 JOHN STILL	1404	864.12
05202200140000	YAN REN MIN	2002 JOHN STILL	2716	2267.59
05202200150000	TY CHHUO/KUNTHEA SEANG	2008 JOHN STILL	2445	2034.24
05202200160000	JAVED TIEPU	2014 JOHN STILL	2716	2163.02
05202200170000	FLORES SOPHIA D	2020 JOHN STILL	3508	2793.77
05202200180000	YANG CHENG Y/LISA C LIANG	2028 BONAVISTA	2190	1433.52
05202200190000	ROJERO JOSE MANUEL	4 MACCAN	2190	1433.52
05202200200000	CASO LISA	11 MACCAN	1260	824.27
05202200210000	KUANG YU Q/TING H YU	5 MACCAN	1190	947.72
05202200220000	JACKSON SHELTON	7875 CALDONIA	1260	824.27
05202200230000	OWL INTERIOR DESIGN LIMITED	7881 CALDONIA	1404	947.72
05202200240000	KUMAR ANSHU	1941 JOHN STILL	1404	947.72
05202200250000	BAKER LYNETTE C	1935 JOHN STILL	1260	824.27
05202200260000	SINGH NITIN/RAJENDAR/NIRMALA	1929 JOHN STILL	2190	1433.52
05202200270000	BEVIKA SINGH REVOCABLE TRUST	1923 JOHN STILL	1638	1304.50
05202200280000	LIANG JIN ZHI	1917 JOHN STILL	2190	1433.52
05202200290000	LARREA MARTA	1911 JOHN STILL	1302	1036.91
05202200300000	JACKSON ELOISE	7864 CALDONIA	1260	824.27
05202200310000	BLACKMAN KHYRA	7858 CALDONIA	1404	947.72
05202200320000	2017 1 IH BORROWER LP	19 HASBRO	1302	1036.91
05202200330000	CHU GUO YE/MELAN ZHANG	25 HASBRO	1638	1304.50
05202200340000	TAN JAMES E H/MOIRA R SISWOYO	31 HASBRO	2190	1433.52
05202200350000	TRUONG DANH/DANH TRAN	30 HASBRO	1638	1304.50
05202200360000	GUAN LISA	24 HASBRO	1302	1036.91
05202200370000	TAN TERRENCE	18 HASBRO	2190	1433.52
05202200380000	SHIRO CARMEN Y	12 HASBRO	1260	824.27
05202200390000	STEWART TANGA RENATA	6 HASBRO	1404	947.72
05202200400000	TRAN BACH/CHI QUE THI TRUONG	1944 BONAVISTA	1638	1304.50

SACRAMENTO CITY UNIFIED SCHOOL DISTRICT
Community Facilities District No. 2
2019-2020
Special Tax Roll

Assessor Parcel Number	Owner	Site Address	Square ft.	CFD #2 Tax
05202200410000	2018 2 IH BORROWER LP	1938 BONAVIDA	2190	1433.52
05202200420000	SINGH SUBASH C/MOHINI L	1926 BONAVIDA	2190	1433.52
05202200430000	SINGH SUBASH C/MOHINI L	1918 BONAVIDA	1302	1036.91
05202200440000	TRAN BINH/DANH	1910 BONAVIDA	1638	1304.50
05202200450000	PRAKASH ANGELINE	1900 BONAVIDA	2190	1433.52
05202200460000	AUGSBURY KENNETH D/KATHRYN R	7751 19TH	1302	1036.91
05202200470000	KWONG DAVID/KWAI MUI	7757 19TH	1638	1304.50
05202200480000	LI YONG H/FENG M JIANG	7763 19TH	2190	1433.52
05202200490000	LO FAMILY TRUST	7769 19TH	1638	1304.50
05202200500000	KUMAR ALVIN A/KUMAR SHERON S	7775 19TH	2190	1433.52
05202200510000	WONG VING CHI/BANG YAN FU/SING	7781 19TH	1638	1304.50
05202200520000	HUANG SHAO X/WAN H MA	7782 19TH	1302	1036.91
05202200530000	CHEN MENGXI	7776 19TH	1638	1304.50
05202200540000	KUANG WAYNE/SUE CUI ZHU YU	7770 19TH	2190	1433.52
05202200550000	ROMERO JUAN	7764 19TH	1638	1304.50
05202200560000	CHAND MONITA/PRAVEEN	7758 19TH	1302	1036.91
05202200570000	VANG PAI/PANG VUE	7752 19TH	2190	1433.52
05202200580000	IH3 PROPERTY WEST LP	7746 19TH	2190	1433.52
05202200590000	TAM CHEE WAH/CINDY XIAO YU CUI	7740 19TH	1638	1304.50
05202200600000	RODRIGUEZ LIVING TRUST	7734 19TH	1302	1036.91
05202200610000	WU ZHINENG	7728 19TH	1302	1036.91
05202200620000	XU LE H/ZUO H WU	7722 19TH	1638	1304.50
05202200630000	ALEXANDER MICHAEL	1907 BONAVIDA	1260	824.27
05202200640000	ZHOU SU JIAN	1901 BONAVIDA	1404	947.72
05202200650000	TSE WAI L A/YAU L	1915 BONAVIDA	2190	1433.52
05202200660000	JEFFREY F/SHANNON C SOLOMON	1921 BONAVIDA	1302	1036.91
05202200670000	SINGH VIRENDRA	1927 BONAVIDA	1638	1304.50
05202200680000	AMIN NEENA/ANANT	1933 BONAVIDA	1638	1304.50
05202200690000	CHANDRA HARISH/SASHI L	1939 BONAVIDA	2190	1433.52
05202200700000	MAHARAJ SMITA	1945 BONAVIDA	1302	1036.91
05202200710000	AVILA GOMEZ SANTIAGO/STEPHANI	1951 BONAVIDA	2190	1433.52
05202200720000	BHARAT BHUSHAN/MANJU	1957 BONAVIDA	1638	1304.50
05202200730000	JING/FEI FAMILY TRUST	1963 BONAVIDA	1302	1036.91
05202200740000	BARBARA A MOORE 2015	1969 BONAVIDA	2190	1433.52
05202200750000	HAU MINDY	1975 BONAVIDA	1638	1304.50
05202200760000	TRUONG BICH N	1981 BONAVIDA	1302	1036.91
05202200770000	2017 1 IH BORROWER LP	1987 BONAVIDA	2190	1433.52
05202200780000	LAI WEI Q/MIN B TANG	1993 BONAVIDA	1638	1304.50
05202200790000	TAN JUNHONG/KEVIN	1999 BONAVIDA	1800	1433.52
05202200800000	CHANDRA ATINESH/ASHA LATA	2005 BONAVIDA	1638	1304.50
05202200810000	CHEN ANDREW H/DORIS	2011 BONAVIDA	1302	1036.91
05202200820000	JIANG XUE X/HONG T LI	2017 BONAVIDA	2190	1433.52

SACRAMENTO CITY UNIFIED SCHOOL DISTRICT
Community Facilities District No. 2
2019-2020
Special Tax Roll

Assessor Parcel Number	Owner	Site Address	Square ft.	CFD #2 Tax
05202200830000	CHEN YANNA	2023 BONAVISTA	1638	1304.50
05202200840000	RUIZ ANGEL OSORIO	2022 BONAVISTA	1638	1304.50
05202200850000	MEJIA ALEJANDRO P/MARISOL	2016 BONAVISTA	1302	1036.91
05202200860000	MWZ & ASSOCIATES LLC	2010 BONAVISTA	1638	1304.50
05202200870000	ZHENG JIANMIN/JENNY Q LEE	2004 BONAVISTA	2190	1433.52
05202200880000	AGULO FAMILY TRUST	1980 BONAVISTA	2190	1433.52
05202200890000	ALI SHAMSHAD/RAJESH KUMAR	1974 BONAVISTA	1638	1304.50
05202200900000	LUU THOMAS	1968 BONAVISTA	2190	1433.52
05202200910000	WHITE SHARON J	1962 BONAVISTA	1638	1304.50
05202200920000	LEI/MEI FAMILY TRUST	1958 BONAVISTA	1302	1036.91
05202200930000	DIXON KASHINA	1954 BONAVISTA	1260	824.27
05202200940000	HERCULES BLANCA E	1950 BONAVISTA	1404	947.72
05202200950000	NGUYEN TU D/LANCHI T	7851 CALDONIA	1638	1304.50
05202200960000	WONG SAM	7857 CALDONIA	1302	1036.91
05202200970000	NG JACK L/VICKI C XIE M	7863 CALDONIA	2190	1433.52
05202200980000	LAL NEERAV M	7869 CALDONIA	1638	1304.50
05202200990000	NGUYEN QUEENDY Q T	17 MACCAN	1638	1304.50
05202201000000	TINAH YEE 2013 REVOCABLE TRUST	23 MACCAN	2190	1433.52
05202201010000	RUSAN SIGHETI DANIELA C/SORIN	22 MACCAN	1638	1304.50
05202201020000	GUZMAN JOSE A/MARIA	16 MACCAN	2190	1433.52
05202201030000	HSIUNG W CHEN/WAIYIN LOUIE	10 MACCAN	1638	1304.50
05202300010000	THIND PRITAM S/GURDEEP KAUR	111 HIGHFIELD	2751	2190.90
05202300020000	FENG MIAO Z/YU J HUANG	121 HIGHFIELD	2177	1415.20
05202300030000	REYNOLDS JOHN	131 HIGHFIELD	3281	2612.99
05202300040000	LAM HIUE/JENNIFER SILAPAN	141 HIGHFIELD	2208	1758.45
05202300050000	LAO JAMIE/THAI VANG	151 HIGHFIELD	2177	1415.20
05202300060000	NAINGGOLAN DAVID S/JOHANNA	161 HIGHFIELD	1777	1415.20
05202300070000	KAUR BALJEET	171 HIGHFIELD	3009	2396.37
05202300080000	GUAN YONG JIAN	181 HIGHFIELD	2177	1415.20
05202300090000	ANJETTER/ROOSEVELT SULLEN JR	191 HIGHFIELD	2208	1758.45
05202300100000	METLENKO LEONID/LYUBOV/VITALIY	201 HIGHFIELD	2208	1758.45
05202300110000	XIAO CHU FAMILY TRUST	211 HIGHFIELD	2177	1415.20
05202300120000	CHAMPAPHONVILAY BOUNLIENG	221 HIGHFIELD	2445	1947.20
05202300130000	PRASAD SASHI P	231 HIGHFIELD	2177	1415.20
05202300140000	DAYAG-WONG MARIBELLE	241 HIGHFIELD	2445	1947.20
05202300150000	KHORN CHAN/KANHA PHON	251 HIGHFIELD	2208	1758.45
05202300160000	DEO CHANDRA/ROSHNI D	261 HIGHFIELD	2713	2160.63
05202300170000	SUNDAR BIPEND	271 HIGHFIELD	2208	1758.45
05202300180000	KAUR JATINDER/KULWANT SINGH	281 HIGHFIELD	2833	1858.00
05202300190000	TRAN HAI/SEN	291 HIGHFIELD	3009	2396.37
05202300200000	MCCULLOUGH BARBARA J	301 HIGHFIELD	2208	1758.45
05202300210000	HEWITT JASON A	311 HIGHFIELD	2833	1858.00

SACRAMENTO CITY UNIFIED SCHOOL DISTRICT
Community Facilities District No. 2
2019-2020
Special Tax Roll

Assessor Parcel Number	Owner	Site Address	Square ft.	CFD #2 Tax
05202300220000	VANG LEE/THAO LEE	321 HIGHFIELD	2713	2160.63
05202300230000	BURNHAM SOO	331 HIGHFIELD	2208	1758.45
05202300240000	KHAN SHABIR/ASMA	341 HIGHFIELD	3009	2396.37
05202300250000	ELLIS SHEILA	351 HIGHFIELD	1260	824.27
05202300260000	EASTER PATRICK/TINA	361 HIGHFIELD	1404	947.72
05202300270000	FREEMAN LESLIE/KONSTANCE	340 HIGHFIELD	2482	1976.66
05202300280000	AGUILAR ZELMAN ROJO/ETAL	330 HIGHFIELD	1260	864.12
05202300290000	RIDDLE BRUCE A	320 HIGHFIELD	1404	993.53
05202300300000	THAO SIA	17 CORTNEY	3281	2739.31
05202300310000	LIN BEN MIN PIN/ANNIE MEI LIN	23 CORTNEY	2445	2041.33
05202300320000	MAHARAJ NATIN/SUKHBINDER	29 CORTNEY	3009	2512.21
05202300330000	CAI SONNY/DIANA	35 CORTNEY	3009	2512.21
05202300340000	PHANTHAI PHILLIP/VICKY P	18 CORTNEY	2716	2267.59
05202300350000	RANGEL ARTHUR JR	12 CORTNEY	1260	864.12
05202300360000	ANEES AHMAD F G	6 CORTNEY	1404	993.53
05202300370000	LAL SACHINDRA	220 HIGHFIELD	2833	1858.00
05202300380000	CHARLES N/BETTY H FONG	210 HIGHFIELD	2445	1947.20
05202300390000	STRALEY RICHARD J	200 HIGHFIELD	2713	2160.63
05202300400000	PENA RANDALL D JR	190 HIGHFIELD	3009	2396.37
05202300410000	MANI PARMILA D/RAYMOND R RAJ	180 HIGHFIELD	2177	1415.20
05202300420000	VUE TONG/ALICE	170 HIGHFIELD	2177	1415.20
05202300430000	NGUYEN DUC T	160 HIGHFIELD	2177	1415.20
05202300440000	MALHOTRA SADHNA/APARNA	150 HIGHFIELD	3281	2612.99
05202300450000	LEONG DAVID M/MEI MEI CHU	140 HIGHFIELD	2177	1415.20
05202300460000	SHARMA JYOTI K/SARALA	7823 MANORSIDE	1404	947.72
05202300470000	TRAN BIEN	7829 MANORSIDE	1260	824.27
05202300480000	NEAL GUY/TERRYLEE	7841 MANORSIDE	3281	2396.37
05202300490000	PRASAD DHIRENDRA/AMRISHA R	7847 MANORSIDE	2177	1415.20
05202300500000	LAM QUACH LIVING TRUST 2014	7855 MANORSIDE	2833	1858.00
05202300510000	TAYLOR RAYMOND/GEMMA GLORY	7861 MANORSIDE	2716	2163.02
05202300520000	K2 VENTURES LLC	7867 MANORSIDE	2208	1758.45
05202300530000	LIN CHUN	7873 MANORSIDE	2482	1976.66
05202300540000	MARTINEZ VELEZ DAMIEN J/VELEZ	7879 MANORSIDE	2833	1858.00
05202300550000	THAO SHARON/YEE H YANG	7889 MANORSIDE	2013	1603.15
05202300560000	CARROLL ANNA	7895 MANORSIDE	1260	824.27
05202300570000	YEOMAN KURT	7899 MANORSIDE	1404	947.72
05202300580000	THAO CHONGVUE C/SANDY VANG	7806 MANORSIDE	2177	1415.20
05202300590000	VUE ANDREW T/CHAMI VANG	7812 MANORSIDE	2177	1415.20
05202300600000	LEE CHAO/BEE	7818 MANORSIDE	2713	2160.63
05202300610000	PARHAR SUKHJIT	7824 MANORSIDE	2833	1858.00
05202300620000	YOKOYAMA RYO	7830 MANORSIDE	2208	1758.45
05202300630000	ZHITKOVA NINA	7836 MANORSIDE	2833	1858.00

SACRAMENTO CITY UNIFIED SCHOOL DISTRICT
Community Facilities District No. 2
2019-2020
Special Tax Roll

Assessor Parcel Number	Owner	Site Address	Square ft.	CFD #2 Tax
05202300640000	GRANDE CHRISTOPHER	7842 MANORSIDE	3236	2577.15
05202300650000	MOUA XAI Y/TONY Y	7848 MANORSIDE	2177	1415.20
05202300660000	SINGH MAUREEN/DURVIJAI/DAN	7854 MANORSIDE	3009	2396.37
05202300670000	2017 2 IH BORROWER LP	7860 MANORSIDE	2713	2160.63
05202300680000	GRAYSON BELINDA	7866 MANORSIDE	2177	1415.20
05202300690000	SHARMA RODNAL R	7872 MANORSIDE	2713	2160.63
05202300700000	PLASCENCIA VICTOR R	7878 MANORSIDE	2333	1858.00
05202300710000	BECKHAM LEANDER DAVID/LORENA	7884 MANORSIDE	2833	1858.00
05202300720000	NGUYEN CUNG	7890 MANORSIDE	2713	2160.63
05202300730000	KUMAR AJAY/SHALINI	2329 EXPEDITION	2713	2160.63
05202500010000	SAECHAO VICKY	2323 EXPEDITION	2716	2267.59
05202500020000	MEGRIKYAN ALBERT/VALENTINA	2317 EXPEDITION	2632	2041.33
05202500030000	HERR BROOKE I	2311 EXPEDITION	2713	2265.08
05202500040000	LU DEQUAN	2305 EXPEDITION	2751	2296.81
05202500050000	BILLINGSLEY SHANA R	4 LETIZIA	1404	993.53
05202500060000	LOVATO TOMASA K	10 LETIZIA	1260	864.12
05202500070000	WONG DAVID	16 LETIZIA	2713	2265.08
05202500080000	HOANG MANH V/KIM HONG LY	22 LETIZIA	2177	1483.62
05202500090000	BALRAJ/GURJIT DHILLON TRUST	15 LETIZIA	2713	2265.08
05202500100000	TRINH MUI A	2115 EXPEDITION	3281	2739.31
05202500110000	SANDHU HARBHAJAN/PARAMJIT	2107 EXPEDITION	2716	2267.59
05202500120000	MAHARAJ OM LATA	2101 EXPEDITION	2177	1483.62
05202500130000	VANG MAI/MAI HER	6 HENSHAW	2445	2041.33
05202500140000	GRANDE ROBERT	12 HENSHAW	2713	2265.08
05202500150000	KHAN HAMID NAWAZ/ZILEHUMA	11 HENSHAW	3508	2928.83
05202500160000	YANG YING/XE	5 HENSHAW	2482	2072.22
05202500170000	BROWN JOYCE T/WILLIS L	2081 EXPEDITION	1404	993.53
05202500180000	MACKLIN ALBERTA	2075 EXPEDITION	1260	864.12
05202500190000	LIANG ZHUO PENG/CUI LIAN CHEN	2069 EXPEDITION	2177	1483.62
05202500200000	SAETEURN CHAN T	2063 EXPEDITION	2833	1947.82
05202500210000	HUNDAL RAMINDER/HARPREET	2057 EXPEDITION	2177	1483.62
05202500220000	DEVI ARUNA/SANIL PRATAP	2051 EXPEDITION	2751	2296.81
05202500230000	MOHAMMED RASHEED HAROLD	2045 EXPEDITION	3009	2512.21
05202500240000	GAVIN ANNER	2039 EXPEDITION	2632	2041.33
05202500250000	NAND NITYA/ASHA DEVI	2033 EXPEDITION	2833	1947.82
05202500260000	DHAR SHIVNESH/SNDIKA D	2027 EXPEDITION	2208	1843.46
05202500270000	NGUYEN HONG T T	2021 EXPEDITION	3281	2739.31
05202500280000	LOPEZ JIMENEZ MARCELO	2015 EXPEDITION	2177	1483.62
05202500290000	LEE CHIA	2007 EXPEDITION	3281	2739.31
05202500300000	LEE CHENG XENG	2001 EXPEDITION	2716	2267.59
05202500310000	CHANDRA AJIT/RAMONA R	2034 EXPEDITION	2833	1947.82
05202500320000	LI HONG H/SHUYU WU	2040 EXPEDITION	2482	2072.22

SACRAMENTO CITY UNIFIED SCHOOL DISTRICT
Community Facilities District No. 2
2019-2020
Special Tax Roll

Assessor Parcel Number	Owner	Site Address	Square ft.	CFD #2 Tax
05202500330000	AUNG MAUNG PHONE M	2046 EXPEDITION	2482	2072.22
05202500340000	RODGER JERRY/CAROLYN E	2052 EXPEDITION	2177	1483.62
05202500350000	CAMPOS JOSE G	2058 EXPEDITION	2713	2265.08
05202500360000	DEVORA MARIA A/RAMIRO	2064 EXPEDITION	3009	2512.21
05202500370000	VANGSHONG LINDA C	2070 EXPEDITION	3009	2512.21
05202500380000	BASQUEZ VICTOR SR/SAMANTHA	2074 EXPEDITION	2208	1843.46
05202500390000	TADEUSZ MARKOWSKI TRUST	2078 EXPEDITION	1260	864.12
05202500400000	ZHU JAY Q/CATHERINE YANCHUN	2082 EXPEDITION	1404	993.53
05202500410000	WILSON KIM K/MARIA	7969 TANTURA	1404	993.53
05202500420000	CHEW JULIE B/SEN TJAI	7963 TANTURA	1260	864.12
05202500430000	PRAKASH RAJNI	7957 TANTURA	2445	2041.33
05202500440000	CHU WAN F/CARMEN W	7951 TANTURA	2482	2072.22
05202500450000	WANG FU/SILING ZHENG	7945 TANTURA	2713	2265.08
05202500460000	NAEATA KAHO	7939 TANTURA	3236	2701.74
05202500470000	WONG HENG CHI	7933 TANTURA	2177	1483.62
05202500480000	VIJAY ANITA	7927 TANTURA	2208	1843.46
05202500490000	LEGASPI MONA L/RICHARD WHALEN	7921 TANTURA	2943	2457.11
05202500500000	WALLS ANICA	7915 TANTURA	3009	2512.21
05202500510000	GUTIERREZ IVON	7909 TANTURA	1260	864.12
05202500520000	RAMOS ERNESTO	7901 TANTURA	1404	993.53
05202600010000	SMITH LATOYA C	1995 EXPEDITION	1404	993.53
05202600020000	CHANG ALFRED/SIOSAN HO	1989 EXPEDITION	1260	864.12
05202600030000	LAL BIMLA/RAM	1983 EXPEDITION	1638	1367.57
05202600040000	HANG SANH/HONG M HUYNH C	1977 EXPEDITION	1302	1087.04
05202600050000	CHAND SANDIP/SANTOSHNA DEVI	1971 EXPEDITION	1638	1367.57
05202600060000	HUANG RUXIN/YAN C ZHAO	1965 EXPEDITION	2190	1502.82
05202600070000	XIE GUO L/HUI	1959 EXPEDITION	1638	1367.57
05202600080000	KURUDIMOVA LYUBOV/STEPAN	1953 EXPEDITION	2190	1502.82
05202600090000	KAIYUM ABDUL/ASHVIN NISHA	1947 EXPEDITION	1638	1367.57
05202600100000	KUANG GUO L	1941 EXPEDITION	1302	1087.04
05202600110000	ALI FEROZA/ISLAM	1935 EXPEDITION	2190	1502.82
05202600120000	NGUYEN HOA VAN/THANH VAN DO	1929 EXPEDITION	1638	1367.57
05202600130000	TORRES ELIZABETH	1923 EXPEDITION	2190	1502.82
05202600140000	THAO DAVID	1917 EXPEDITION	1302	1087.04
05202600150000	CHAND CHRISTINE U/DIWAN	1911 EXPEDITION	1638	1367.57
05202600160000	LLAMAS RAFAEL LOPEZ	1905 EXPEDITION	1260	864.12
05202600170000	GREENLEAVES TRUST	1901 EXPEDITION	1404	993.53
05202600180000	T2S2 PROPERTIES LLC	1994 EXPEDITION	1638	1367.57
05202600190000	KONG LAI M/SHU H LEUNG	1988 EXPEDITION	2190	1502.82
05202600200000	JEET DINAY V/ANGELINE A	1982 EXPEDITION	1638	1367.57
05202600210000	GAO FENG/YAN HONG	1976 EXPEDITION	2190	1502.82
05202600220000	LIANG HANCHENG/BAOFENG DUAN	1970 EXPEDITION	1800	1502.82

SACRAMENTO CITY UNIFIED SCHOOL DISTRICT
Community Facilities District No. 2
2019-2020
Special Tax Roll

Assessor Parcel Number	Owner	Site Address	Square ft.	CFD #2 Tax
05202600230000	BRAVO PEDRO/ROMELIA	1964 EXPEDITION	1638	1367.57
05202600240000	LEE DAVID	1958 EXPEDITION	2190	1502.82
05202600250000	LOU MY D/PHAI M KHONG	1952 EXPEDITION	1638	1367.57
05202600260000	QUILICI MICHAEL A/KATHRYN/LISA	1946 EXPEDITION	1302	1087.04
05202600270000	HUYNH KIM H T/KY D NGUYEN	1940 EXPEDITION	2190	1502.82
05202600280000	RECINOS VICTOR/IRMA	7901 TUNGSTEN	1260	993.53
05202600290000	TAN CUITING	7907 TUNGSTEN	1404	864.12
05202600300000	TIPTON ZAKIA ARFANA SHAMIM	7915 TUNGSTEN	1302	1087.04
05202600310000	PATRIA R WOLFE TRUST 2018	7921 TUNGSTEN	1638	1367.57
05202600320000	2018 PATRIA R WOLFE TRUST/ETAL	7927 TUNGSTEN	2190	1502.82
05202600330000	TAMMY V GOOCH REVOCABLE	7933 TUNGSTEN	1638	1367.57
05202600340000	GIDEON/MIRIAM NAIR 2017 TRUST	7939 TUNGSTEN	2190	1502.82
05202600350000	SAECHAO NAI	7945 TUNGSTEN	1638	1367.57
05202600360000	CHIAO JONATHAN/SHERYL BAYLON	7951 TUNGSTEN	1302	1087.04
05202600370000	SHETAB SADEQ	7957 TUNGSTEN	1638	1367.57
05202600380000	NAND NITYA/JAIKUMARI	1919 ESTEREL	1302	1087.04
05202600390000	SHARMA NIKUNJ/NEETU JAISWAL	1925 ESTEREL	1638	1367.57
05202600400000	VANG KAAY/DENOTE	1931 ESTEREL	2190	1502.82
05202600410000	BURNHAM SOO	1937 ESTEREL	1638	1367.57
05202600420000	NGUYEN LOAN A/VUONG VU	1943 ESTEREL	2190	1502.82
05202600430000	DATT DEVIKA/KRISHNA	1949 ESTEREL	1638	1367.57
05202600440000	LAL RAM/BIMLA	1955 ESTEREL	1302	1087.04
05202600450000	LIANG ZHUO Z/HUI Z	1961 ESTEREL	1638	1367.57
05202600460000	CHANG SEE/ANUKUN SAEWANG	1967 ESTEREL	2190	1502.82
05202600470000	BOSCO WAI Z O	1973 ESTEREL	1638	1367.57
05202600480000	FUNG NGAI PUN	1979 ESTEREL	2190	1502.82
05202600490000	HU YING H/JIN W LIANG	1985 ESTEREL	1638	1367.57
05202600500000	IMRAZ ZABIA B	1991 ESTEREL	1302	1087.04
05202600510000	MCCULLOUGH JAMES E	1995 ESTEREL	1260	864.12
05202600520000	MORALES ALVARO/MARIA E	1999 ESTEREL	1404	993.53
05202700010000	ROBLES CRISTINA/CECILIA	1950 ESTEREL	2190	1502.82
05202700020000	LIN SHAUN/HELENA MEI	1956 ESTEREL	1638	1367.57
05202700030000	HILLVIEW INVESTMENT LLC	1962 ESTEREL	2190	1502.82
05202700040000	ZHANG LU	1968 ESTEREL	1638	1367.57
05202700050000	LIANG HANCHENG/BAOFENG DUAN	1974 ESTEREL	2190	1502.82
05202700060000	KAM MUY/AUNE CHAU	1980 ESTEREL	1638	1367.57
05202700070000	KURUDIMOVA LIUDMILA/PETR	1986 ESTEREL	2190	1502.82
05202700080000	NGAI SING W	1992 ESTEREL	2190	1502.82
05202700090000	PHON DY	1996 ESTEREL	1638	1367.57
05202700100000	DIEP KEVIN	2002 ESTEREL	3281	2512.21
05202700110000	VANG SAI	8 JEANROSS	2482	2072.22
05202700120000	SOTELO TOMAS SR/GILDA P	14 JEANROSS	2713	2265.08

SACRAMENTO CITY UNIFIED SCHOOL DISTRICT
Community Facilities District No. 2
2019-2020
Special Tax Roll

Assessor Parcel Number	Owner	Site Address	Square ft.	CFD #2 Tax
05202700130000	XIONGXTOYED PADEE/LENG MOUA	20 JEANROSS	3009	2512.21
05202700140000	SINGH	26 JEANROSS	2713	2265.08
05202700150000	CHEN CHAOLONG	21 JEANROSS	3009	2512.21
05202700160000	UPPAL AMANDEEP/UPPINDER S	15 JEANROSS	2751	2296.81
05202700170000	TADEUSZ MARKOWSKI TRUST	9 JEANROSS	1260	864.12
05202700180000	SMITH TERENCE	3 JEANROSS	1404	993.53
05202700190000	WILSON KIM/MARIA	2039 RICHFIELD	1404	993.53
05202700200000	MARQUEZ MARIA DE JESUS	2033 RICHFIELD	1260	864.12
05202700210000	LUU THYTU THI	2027 RICHFIELD	3508	2928.83
05202700220000	KUMAR NEELIYA H	2021 RICHFIELD	2833	1947.82
05202700230000	SAECHAO SENG/STACY M	2015 RICHFIELD	2445	2041.33
05202700240000	LEE LOUAWA/RAYMOND/FAHM S	2007 RICHFIELD	3508	2928.83
05202700250000	COMMER DAVID	2001 RICHFIELD	2445	2041.33
05202700260000	AC/RM LIVING TRUST	1997 LEFORD	2716	2267.59
05202700270000	LIN MIN/WENBIN HE	1993 LEFORD	1302	1087.04
05202700280000	MARKIEWITZ TROY	1987 LEFORD	2190	1502.82
05202700290000	STELLMACHER KAREN S/ELIZABETH	1983 LEFORD	1638	1367.57
05202700300000	VUE KHU	1979 LEFORD	2190	1502.82
05202700310000	KULKARNI ALKA ASHOK	1975 LEFORD	1638	1367.57
05202700320000	SINGH RAKESH	4 VAN HORN	1404	993.53
05202700330000	SINGH RAKESH	10 VAN HORN	1260	864.12
05202700340000	TSE CHUN ON/NANCY M GEE	16 VAN HORN	1638	1367.57
05202700350000	VIGIL-MENDEZ EDDIE MALO/MARY	22 VAN HORN	2190	1502.82
05202700360000	LEE POM R	21 VAN HORN	1638	1367.57
05202700370000	GLASS VINCE/KATHERINE STERN	15 VAN HORN	1302	1087.04
05202700380000	HENDRIX KELLI	7 VAN HORN	2190	1502.82
05202700390000	VANG JONATHAN T	1908 ESTEREL	2190	1502.82
05202700400000	GARCIA ALEJANDRO/GISELA	1914 ESTEREL	1638	1367.57
05202700410000	SINGH SALENDRA/SUNILA	1920 ESTEREL	2190	1502.82
05202700420000	DIAZ-VEGA JOEL	1943 LEFORD	1404	993.53
05202700430000	MUNN MARK JR	1937 LEFORD	1260	864.12
05202700440000	GAO XIAO QIN	1933 LEFORD	2190	1502.82
05202700450000	ESTRADA JOSE LUIS	1927 LEFORD	1638	1367.57
05202700460000	THR CA LIMITED PARTNERSHIP	1921 LEFORD	2190	1502.82
05202700470000	ALVARADO SONIA D	1915 LEFORD	1638	1367.57
05202700480000	WARE CARLA	1907 LEFORD	1260	864.12
05202700490000	CARDOZA MANUEL LEAL	1901 LEFORD	1404	993.53
05202700500000	STERN ERIK D	1900 LEFORD	1404	993.53
05202700510000	YOUNGER MELISSA L	1906 LEFORD	1260	864.12
05202700520000	CAMACHO HERIC TORRES	1914 LEFORD	1302	1087.04
05202700530000	NAVARRO JUAN ANTONIO RIOS	1920 LEFORD	1638	1367.57
05202700540000	NHAN KHANH/YING WEN YAN	1926 LEFORD	1800	1502.82

SACRAMENTO CITY UNIFIED SCHOOL DISTRICT
Community Facilities District No. 2
2019-2020
Special Tax Roll

Assessor Parcel Number	Owner	Site Address	Square ft.	CFD #2 Tax
05202700550000	ROYAL ESTATE HOLDINGS LLC	1932 LEFORD	1302	1087.04
05202700560000	FEOKTISTOV DANIIL/IRINA A	1938 LEFORD	1638	1367.57
05202700570000	CHERNYAVSKAYA GALINA	1944 LEFORD	2190	1502.82
05202700580000	PARMETT MICHAEL B/JEANETTE	1950 LEFORD	1638	1367.57
05202700590000	ARUNKUMAR VIJAYKUMAR	1956 LEFORD	2190	1502.82
05202700600000	KUMAR KIRTI K	1962 LEFORD	1638	1367.57
05202700610000	CISNEROS SERGIO/TIFFANY E	1968 LEFORD	1302	1087.04
05202700620000	PRISCILLA H PRICE DAVIS REV	1974 LEFORD	1638	1367.57
05202700630000	REDDY VINAL/ROBINA	1982 LEFORD	1302	1087.04
05202700640000	HER MIKE	1986 LEFORD	2190	1502.82
05202700650000	MEI MICHELLE	1987 RICHFIELD	2716	2267.59
05202700660000	SINGH AJENDRA A/SHEENA	1981 RICHFIELD	2716	2267.59
05202700670000	YUANLIN XIE/HONG YE REVOCABLE	1975 RICHFIELD	2177	1483.62
05202700680000	TRUONG TUYET D	1969 RICHFIELD	2333	1947.82
05202700690000	VANG NHIA/MAI J LEE	1963 RICHFIELD	2833	1947.82
05202700700000	PHUC NGUYEN/TUYET T LE AB LVNG	1957 RICHFIELD	2177	1483.62
05202700710000	SAICHAO DENNISE/MEY C	1951 RICHFIELD	3508	2928.83
05202700720000	RAJ PATRICK/AMISHA	1945 RICHFIELD	2833	1947.82
05202700730000	HERNANDEZ ANGIE	1939 RICHFIELD	2177	1483.62
05202700740000	MUMTAZ MOHAMMAD/NADEEM A	1933 RICHFIELD	3508	2928.83
05202700750000	PHRAXAYA KEVIN/KRISTEN	1927 RICHFIELD	2716	2267.59
05202700760000	YANG MAY	1921 RICHFIELD	3508	2928.83
05202700770000	KAUR BALJEET	1915 RICHFIELD	1777	1483.62
05202700780000	LAL SURENDRA/SINDHULA K	1907 RICHFIELD	3281	2739.31
05202700790000	KASIM RINA	1901 RICHFIELD	2482	2072.22
05301600010000	YABUT LANCE	7777 LARAMORE	1232	931.39
05301600020000	YABUT JAIME V/SHIRLEY S	7773 LARAMORE	1624	1227.74
05301600030000	VANG SUNNY	7769 LARAMORE	1859	1405.40
05301600040000	SCOTT ROSALYNN D	7765 LARAMORE	1232	931.39
05301600050000	HAWJ CHARLES/MICKEY YANG	7761 LARAMORE	1624	1227.74
05301600060000	CAPINDIAN ARIEL/TEODORA	7757 LARAMORE	1232	931.39
05301600070000	SMITH LAINE WARREN/ROBERT	7753 LARAMORE	1624	1227.74
05301600080000	TOBIAS KATHY	7749 LARAMORE	1859	1405.40
05301600090000	GAINES RONALD M/GAINES LINDA	7745 LARAMORE	1859	1454.85
05301600100000	GONZALEZ JESUS	7743 LARAMORE	1232	964.16
05301600110000	GUAN JARED C	7741 LARAMORE	1624	1270.94
05301600120000	YANG XI Y	7739 LARAMORE	1662	1316.30
05301600130000	GAUDCHOUX CHARLES E/GRACE C	7737 LARAMORE	1859	1405.40
05301600140000	VELAZQUEZ SANCHEZ CARLOS	7735 LARAMORE	1624	1227.74
05301600150000	CERVANTES JESSE	7733 LARAMORE	1232	931.39
05301600160000	MCDONNELL KAMERON F/KEVIN	7731 LARAMORE	1624	1227.74
05301600170000	HUANG WENDA/CUIHUI YANG	7729 LARAMORE	1859	1405.40

SACRAMENTO CITY UNIFIED SCHOOL DISTRICT
Community Facilities District No. 2
2019-2020
Special Tax Roll

Assessor Parcel Number	Owner	Site Address	Square ft.	CFD #2 Tax
05301600180000	HUANG ZHEN F/JIEQING LI	7727 LARAMORE	1624	1227.74
05301600190000	OBANDO FRANCISCO J/MARIA O	7725 LARAMORE	1232	931.39
05301600200000	UCLARAY	7723 LARAMORE	1624	1227.74
05301600210000	TA ALAIN	7721 LARAMORE	1232	931.39
05301600220000	SEGOVIANO ANTONIO	7719 LARAMORE	1624	1227.74
05301600230000	HUANG SALLY/MIKE WANG	7717 LARAMORE	1232	931.39
05301600240000	LEE YUA	7715 LARAMORE	1859	1405.40
05301600250000	NGUYEN PHUONG H/TRI H/DONG T	7780 DIXIE LOU	1900	1504.80
05301600260000	SUNSHINE X LLC	7776 DIXIE LOU	1662	1316.30
05301600270000	FORGHANI ARTEMIS	7772 DIXIE LOU	1200	950.40
05301600280000	THAO KER/SAY	7768 DIXIE LOU	1900	1504.80
05301600290000	TROPEL ELIZABETH J/JOSE N A	7764 DIXIE LOU	1624	1286.21
05301600300000	THI T LE/JULIA V AB LIVING TRUST	7760 DIXIE LOU	1200	950.40
05301600310000	KHARCHENKO OLESYA	7756 DIXIE LOU	1624	1286.21
05301600320000	MAN/GAO FAMILY TRUST	7752 DIXIE LOU	1900	1504.80
05301600330000	BANKS TERRI A	7748 DIXIE LOU	1662	1316.30
05301600340000	ZAMBRANO HUMBERTO Z	7744 DIXIE LOU	1624	1286.21
05301600350000	JOE/JENNY CHEN REVOCABLE	7740 DIXIE LOU	1200	950.40
05301600360000	AUTAR MAUREEN D	7734 DIXIE LOU	1900	1504.80
05301600370000	HER FONG/MAY LEE	7730 DIXIE LOU	1624	1286.21
05301600380000	KEVIN T LUONG/QUYEN T LY	7726 DIXIE LOU	1200	950.40
05301600390000	LOPEZ ALBERTO G/MARIA L	7722 DIXIE LOU	1900	1504.80
05301600400000	CHANG CHIANG P/SHONG VANG	7777 DIXIE LOU	1859	1413.03
05301600410000	OKAFOR EBERE/BERNARD	7773 DIXIE LOU	1662	1263.29
05301600420000	SATISH/KESHNI KUMAR REVOCABLE	7769 DIXIE LOU	1624	1234.40
05301600430000	YE WEI/YOU JUAN	7765 DIXIE LOU	1859	1413.03
05301600440000	ABDUL RAHMAN ELIGAH	7761 DIXIE LOU	1232	936.44
05301600450000	ACKLIN HOLLIS E	7757 DIXIE LOU	1624	1286.21
05301600460000	VALLES TONY/YANGMEE	7753 DIXIE LOU	1662	1316.30
05301600470000	NAVARRETE ERNESTO	7749 DIXIE LOU	1900	1504.80
05301600480000	GALANG EMILITO M/MA TERESA M	7745 DIXIE LOU	1200	950.40
05301600490000	KOTHULE JAYA S/SANJAY C	7741 DIXIE LOU	1624	1286.21
05301600500000	CAMACHO MANUEL LEYVA	7737 DIXIE LOU	1200	950.40
05301600510000	NHAN KHANH/YING W Y	7733 DIXIE LOU	1900	1504.80
05301600520000	RAZAQ ASIF J/IRAM SHAHZADI	7729 DIXIE LOU	1624	1286.21
05301600530000	KUMAR KIRTI K	7725 DIXIE LOU	1200	950.40
05301600540000	2017 1 IH BORROWER LP	7721 DIXIE LOU	1900	1504.80
05301600550000	IGOT TERRY A JR/WILDA	7744 LARAMORE	1859	1405.40
05301600560000	MCNEILLY TRICIA L	7742 LARAMORE	1662	1316.30
05301600570000	NISHA SAIRA NUR/RASHEED USMAN	7740 LARAMORE	1624	1227.74
05301600580000	SYDNOR CLAUDINE	7738 LARAMORE	1859	1405.40
05301600590000	KHILANI ANIL/SURAJ PARKASH	7736 LARAMORE	1624	1227.74

SACRAMENTO CITY UNIFIED SCHOOL DISTRICT
Community Facilities District No. 2
2019-2020
Special Tax Roll

Assessor Parcel Number	Owner	Site Address	Square ft.	CFD #2 Tax
05301600600000	ORIYAVONG	7734 LARAMORE	1662	1316.30
05301600610000	GUAN SULLY	7732 LARAMORE	1624	1227.74
05301600620000	SUNSHINE X LLC	7730 LARAMORE	1859	1405.40
05301600630000	LO TSZ P/PUI L CHENG	7728 LARAMORE	1624	1227.74
05301600640000	THORNTON WILSON	7726 LARAMORE	1232	931.39
05301600650000	KHAMTHEVANKHIRY	7724 LARAMORE	1624	1227.74
05301600660000	TRAN PATRICK H	7722 LARAMORE	1859	1405.40
05301600670000	ROUX RAUL F/MARY GRACE P	7720 LARAMORE	1232	931.39
05301600680000	BHARAT BHUSHAN/MANJU	7718 LARAMORE	1624	1227.74
05301600690000	SAECHAO CHENG CHOW	7716 LARAMORE	1859	1405.40
06302400010000	SEVRUK TANYA	9180 SUNFIRE	1176	902.23
06302400020000	LIEU YEN/TIN H	9176 SUNFIRE	1344	1031.12
06302400030000	NGUYEN KENNY/KATIE TRAN	9172 SUNFIRE	1344	1031.12
06302400040000	GIRALDO PAOLA BASSO/JULIAN	9168 SUNFIRE	1483	1137.76
06302400050000	DEWALD ADRIAN T/JENNIFER A	9164 SUNFIRE	1474	1079.26
06302400060000	PEMBERTON CYNTHIA	9160 SUNFIRE	1330	973.83
06302400070000	NGUYEN THIN DUY	9156 SUNFIRE	1474	1079.26
06302400080000	MCGLASHAN GUADALUPE	9152 SUNFIRE	1330	973.83
06302400090000	LEE HYUN SOO	9148 SUNFIRE	1474	1079.26
06302400100000	KIMBERLEY ENGSTROM/LINDA	9144 SUNFIRE	1165	853.01
06302400110000	CISNEROS ASSUNTA L/RUDY A	9140 SUNFIRE	1330	973.83
06302400120000	CARTRIGHT CONSUELO I/ROY L	9136 SUNFIRE	1474	1079.26
06302400130000	VELARDE VINCENT M/TAMMY M	9132 SUNFIRE	1165	853.01
06302400140000	SINGH ARMINDER	9128 SUNFIRE	1330	973.83
06302400150000	CAO MINH H	9124 SUNFIRE	1474	1079.26
06302400160000	CATE DENNIS A/JESSICA F	9120 SUNFIRE	1330	973.83
06302400170000	CONNELLY JOHN W/HEATHER S	9116 SUNFIRE	1165	853.01
06302400180000	CARDWELL TYLER/ELIZABETH	9112 SUNFIRE	1330	973.83
06302400190000	MUNOZ MARIA DE JESUS C/JAVIER	9108 SUNFIRE	1165	853.01
06302400200000	TUFANOV MARIYA/NIKOLAY	9104 SUNFIRE	1474	1079.26
06302400210000	MCDANIEL KEVIN	9336 ROSE PARADE	1165	853.01
06302400220000	LASTRA JULIE A/WILLIAM J HECHT	9337 ROSE PARADE	1165	853.01
06302400230000	PANKOV LYUDMILA	9101 SUNFIRE	1474	1079.26
06302400240000	ROLES JANET C	9105 SUNFIRE	1165	853.01
06302400250000	BEAVER MARK S/LIXIN FU	9109 SUNFIRE	1330	973.83
06302400260000	LEYVA JUAN CARLOS	9113 SUNFIRE	1165	853.01
06302400270000	FEDERIGAN JANET I	9117 SUNFIRE	1483	1137.76
06302400280000	BIONDI KENNETH A/YAN LIU	9121 SUNFIRE	1330	973.83
06302400290000	DATSYUK TETYANA	9113 IRISH GOLD	1474	1079.26
06302400300000	NATYAZHKO ANNA/MIKHAIL	9117 IRISH GOLD	953	697.79
06302400310000	HOU SHANDAN	9121 IRISH GOLD	1330	973.83
06302400320000	DOAN BAO G	9125 IRISH GOLD	1165	853.01

SACRAMENTO CITY UNIFIED SCHOOL DISTRICT
Community Facilities District No. 2
2019-2020
Special Tax Roll

Assessor Parcel Number	Owner	Site Address	Square ft.	CFD #2 Tax
06302400330000	YBARRA CHERYL	9129 IRISH GOLD	1330	973.83
06302400340000	HORWOOD LAUREN	9133 IRISH GOLD	1474	1079.26
06302400350000	AUGER APRIL	9137 IRISH GOLD	1330	973.83
06302400360000	BONDI FAMILY TRUST	9136 IRISH GOLD	953	697.79
06302400370000	WOODMAN WHITELAW FAMILY	9132 IRISH GOLD	1330	973.83
06302400380000	MOSEYCHUK TATYANA/VALERIY	9128 IRISH GOLD	1165	853.01
06302400390000	RUSSICK KATHERINE J	9124 IRISH GOLD	953	697.79
06302400400000	PERRAULT BARBARA	9120 IRISH GOLD	1165	853.01
06302400410000	STEWART BAILEY/MICHELLE	9116 IRISH GOLD	1176	902.23
06302400420000	TAYLOR TRUST	9112 IRISH GOLD	1330	973.83
06302400430000	KAZEMI JAMAL	9171 SUNFIRE	1330	973.83
06302400440000	CABRERA RACHEL MICHELLE LANE	9175 SUNFIRE	953	697.79
06302400450000	LU DUC/LAN LUU	9179 SUNFIRE	1474	1079.26
06302400460000	STYERS HEATHER	9183 SUNFIRE	953	697.79
06302400470000	SILVIA CASTRO 1994 TRUST	9187 SUNFIRE	1330	973.83
06302400480000	ZARATE FERDINAND/MARGARITA	9191 SUNFIRE	1474	1079.26
06302400490000	APPLIED BEHAVIOR CONSULTANTS	9195 SUNFIRE	1330	973.83
06302400500000	GRAVADOR RODEL BRIAN	9199 SUNFIRE	1474	1079.26
06302400510000	HOWELL ANDREW JR	9198 SUNFIRE	953	697.79
06302400520000	DAWSON KAREN ANNETTE	9194 SUNFIRE	1330	973.83
06302400530000	TA SENG	9190 SUNFIRE	1474	1079.26
06302400600000	STYRTA IRINA	9320 ROSE PARADE	1330	973.83
06302400610000	GIANG CAM/TUONG K TIEN/MANDA	9314 ROSE PARADE	1474	1079.26
06302400620000	MARTYNYUK MARYAN/TATYANA	9308 ROSE PARADE	1330	973.83
06302400630000	NGUYEN TRINH/TRINH HAI	9304 ROSE PARADE	1474	1079.26
06302400640000	WILLIAMS REVOCABLE LIVING	9300 ROSE PARADE	1330	973.83
06302400650000	REIGEL FRANK O/MARY S	9296 ROSE PARADE	1474	1079.26
06302400660000	CONTRERAS ANGELINA T/MARCOS	9292 ROSE PARADE	1330	973.83
06302400670000	SCHWEDE VINCENT/JACQUELINE	9288 ROSE PARADE	1474	1079.26
06302400680000	PHAVINDHU THANAT/CLAUDIA M	9284 ROSE PARADE	1330	973.83
06302400690000	BERT CUNNINGHAM REVOCABLE	9280 ROSE PARADE	1474	1079.26
06302400700000	FARINIAS FAMILY REVOCABLE	9276 ROSE PARADE	1330	973.83
06302400710000	DONNA J WILCOX REVOCABLE	9272 ROSE PARADE	1165	853.01
06302400720000	CHESSHIRE ANDREW H/SHAR ANNE	9268 ROSE PARADE	953	697.79
06302400730000	SHUKLA PRAKASH G	9264 ROSE PARADE	1330	973.83
06302400740000	CAMPA MANUEL/LUIS	9260 ROSE PARADE	1165	853.01
06302400750000	ROMERO OTILIA SOCORRO	9256 ROSE PARADE	953	697.79
06302400760000	LE ANH T	9252 ROSE PARADE	1483	1137.76
06302400770000	KAPUSH VOLODYMYR	9248 ROSE PARADE	1330	973.83
06302400780000	EDWARDS JERRY	9244 ROSE PARADE	1165	853.01
06302400790000	CULVER ROBERT W	9240 ROSE PARADE	1330	973.83
06302400800000	ROGER M EMERSON REVOCABLE	9236 ROSE PARADE	1165	853.01

SACRAMENTO CITY UNIFIED SCHOOL DISTRICT
Community Facilities District No. 2
2019-2020
Special Tax Roll

Assessor Parcel Number	Owner	Site Address	Square ft.	CFD #2 Tax
06302400810000	DANIELS DANA A	9232 ROSE PARADE	953	697.79
06302400820000	KIRK PHILLIPS LIVING TRUST	9228 ROSE PARADE	1165	853.01
06302400830000	DARRETT FE L/MICHAEL R	9224 ROSE PARADE	1330	973.83
06302400840000	KHMYZ VASILYI/SUSANA	9241 ROSE PARADE	1330	973.83
06302400850000	HAYES DEBORA V/TERRY M	9245 ROSE PARADE	1330	973.83
06302400860000	MONICA SAO/PHALLA PEN	9249 ROSE PARADE	1470	1076.33
06302400870000	DEVARD DARIN M	9253 ROSE PARADE	1330	973.83
06302400880000	NGUYEN TO HAO THUY/HUNG T	9257 ROSE PARADE	1470	1076.33
06302400890000	GREGG JOAN N/ALAN LUKKA	9261 ROSE PARADE	1330	973.83
06302400900000	KELLY TREVA/TERRY HOWARD	9281 ROSE PARADE	1165	853.01
06302400910000	WOMACK NADINE/ROLAND	9285 ROSE PARADE	1483	1137.76
06302400920000	MONTANEZ JULIO/MARIA YVANIA	9289 ROSE PARADE	1165	853.01
06302400930000	LIN YILIN	9293 ROSE PARADE	1344	1031.12
06302400940000	MISHCHUK LUBOV/VITALIY	9297 ROSE PARADE	1483	1137.76
06302400950000	PONCE SANCHEZ DERICK/SANCHEZ	9301 ROSE PARADE	1344	1031.12
06302400960000	LOYD & PENNY BLALOCK LIVING	9305 ROSE PARADE	1165	853.01
06302400970000	LEWIS DEBRA M	9309 ROSE PARADE	1344	1031.12
06302400980000	SINGH NASHVINDER	9313 ROSE PARADE	1165	853.01
06302400990000	AGARKOVA OLGA	9317 ROSE PARADE	1344	1031.12
06302401000000	2017 1 IH BORROWER LP	9321 ROSE PARADE	1483	1137.76
06302401020000	SHUKLA BHASKAR/CHHAYA	9329 ROSE PARADE	1344	1031.12
06302401030000	KUNITAKE KAREN	9333 ROSE PARADE	953	697.79
06302401040000	SINAROM CHAU PECH & NINA	9141 IRISH GOLD	1483	1137.76
06302401050000	LOUPRASONG SOUKSARA/VERNON	9145 IRISH GOLD	1344	1031.12
06302401060000	VOLKOVAS YULIYA	9149 IRISH GOLD	1344	1031.12
06302401070000	JASON S/LINA L LEE FAMILY TRUST	9153 IRISH GOLD	1176	902.23
06302401080000	GREVETT KALEIGH A/HENREY	9157 IRISH GOLD	1344	1031.12
06302401090000	LOGAN LAWRENCE LEE JR/DAWN	9161 IRISH GOLD	1483	1137.76
06302401100000	DOUG SETTELL/JOANNE OTTENS	9165 IRISH GOLD	1344	1031.12
06302401110000	TAYLOR DEE M/ROBERT A	9169 IRISH GOLD	960	736.51
06302401120000	PULKA GLORIA	9173 IRISH GOLD	1344	1031.12
06302401130000	SUSAN GIANNINI LIVING TRUST	9177 IRISH GOLD	1165	853.01
06302401140000	VOLOKITIN MARIYA	9181 IRISH GOLD	1470	1076.33
06302401150000	GUDOVA DIANA/NATALYA	9185 IRISH GOLD	1470	1076.33
06302401160000	COOK LORI A/MICHAEL R	9189 IRISH GOLD	1344	1031.12
06302401170000	HERRERA DAVID/DANA	9193 IRISH GOLD	953	697.79
06302401180000	CAPASSO KEITH	9197 IRISH GOLD	1165	853.01
06302401190000	ZDRAGAT ILIE	9201 IRISH GOLD	1470	1076.33
06302401200000	COOPER REVOCABLE TRUST	9205 IRISH GOLD	1344	1031.12
06302401210000	LONG GERALD L/KATHY L	9176 IRISH GOLD	1470	1076.33
06302401220000	PEREZ JULIO	9172 IRISH GOLD	1165	853.01
06302401230000	TRAN HENRY/CATHERINE KHUC	9168 IRISH GOLD	1344	1031.12

SACRAMENTO CITY UNIFIED SCHOOL DISTRICT
Community Facilities District No. 2
2019-2020
Special Tax Roll

Assessor Parcel Number	Owner	Site Address	Square ft.	CFD #2 Tax
06302401240000	HOLCOMB MICHAEL/LINDSAY	9164 IRISH GOLD	1483	1137.76
06302401250000	KONEFAL EDWARD	9160 IRISH GOLD	1176	902.23
06302401260000	TRAN JESSICA T/HUONG T T	9156 IRISH GOLD	1483	1137.76
06302401270000	MUNDAY PAUL LINDSEY/CAROLYN	9152 IRISH GOLD	1344	1031.12
06302401280000	CHILDERS JIM	9148 IRISH GOLD	1483	1137.76
06302401290000	YI JAE H	9144 IRISH GOLD	1176	902.23
06302401300000	TCHANG WILLIAM T	9140 IRISH GOLD	1344	1031.12
06302401310000	CARROW HARRY G/CARROW RITA	9203 SUNFIRE	1344	1031.12
06302401320000	BRITTA MARY ELLEN	9207 SUNFIRE	1176	902.23
06302401330000	MYERS TONJA M	9211 SUNFIRE	1344	1031.12
06302401340000	ELLIOTT JOHN M	9215 SUNFIRE	1344	1031.12
06302401350000	WILLIAMS FAMILY TRUST	9219 SUNFIRE	1176	902.23
06302401360000	TOOF GLENN D/LISA	9223 SUNFIRE	1344	1031.12
06302401370000	BLYTHE SANDRA PEREZ	9227 SUNFIRE	960	736.51
06302401380000	MENDOZA BETANCOURT BELEN	9231 SUNFIRE	1165	853.01
06302401390000	OLIFERCHIK NATALYA/SERGEY	9235 SUNFIRE	1470	1076.33
06302401400000	MACIAS JAVIER V	9258 SUNFIRE	1330	973.83
06302401410000	IH6 PROP WEST LIMITED	9254 SUNFIRE	1470	1076.33
06302401420000	MARG CANDICE G	9250 SUNFIRE	953	697.79
06302401430000	JENNINGS FAMILY TRUST	9246 SUNFIRE	1344	1031.12
06302401440000	BALATBAT IMELDA/LEO LYNDON	9242 SUNFIRE	1483	1137.76
06302401450000	BETTY D FACIANE LIVING TRUST	9238 SUNFIRE	1344	1031.12
06302401460000	BRUCE E/C CLARK TRUST	9234 SUNFIRE	1165	853.01
06302401470000	SMITH LUIS A	9230 SUNFIRE	1344	1031.12
06302401480000	NER AMADO JR	9226 SUNFIRE	1344	1031.12
06302401490000	NORBORG PETER/MAYGAN D	9222 SUNFIRE	1176	902.23
06302401500000	SHOEMAKER JAMES E/JANICE A	9218 SUNFIRE	1344	1031.12
06302401520000	BAILEY JENNIFER	9210 SUNFIRE	1344	1031.12
06302401530000	2018 3 IH BORROWER LP	9206 SUNFIRE	1176	902.23
06302401540000	SUMMERHAYS FAMILY TRUST	9202 SUNFIRE	1344	1031.12
06302401550000	LOPEZ ANNA M/PATRICK A PIAZZA	9330 ROSE PARADE	1330	973.83
06302401570000	LAWRENCE SANDRA L	9214 SUNFIRE	960	736.51
06302401580000	GERALD E/ANN M STEINKE	9325 ROSE PARADE	1176	902.23
06302401590000	MAC ANNIE	9326 ROSE PARADE	1483	1137.76
06302500010000	ZUFELT FORREST M/CHERISE L	4432 HEDGE	1176	902.23
06302500020000	CERULEAN ESTATES LLC	4428 HEDGE	953	697.79
06302500030000	SAKSENA SHETUL	4424 HEDGE	1165	853.01
06302500040000	MCGINTY KAREN L/CALEB D	4420 HEDGE	1330	973.83
06302500050000	GREWAL LIVING TRUST	4416 HEDGE	1474	1079.26
06302500060000	RAMADAN MOAMEN	4412 HEDGE	1344	1031.12
06302500070000	DANG THUAN	4408 HEDGE	1483	1137.76
06302500080000	AMADI ELIZABETH C	4400 HEDGE	1165	853.01

SACRAMENTO CITY UNIFIED SCHOOL DISTRICT
Community Facilities District No. 2
2019-2020
Special Tax Roll

Assessor Parcel Number	Owner	Site Address	Square ft.	CFD #2 Tax
06302500090000	DEAL ALAN B/BARBARA A/EMILY	4349 HEDGE	953	697.79
06302500100000	SARAZEN MICAELA G/KEVIN J	4403 HEDGE	1330	973.83
06302500110000	WEST MARIA CATHERINE	4407 HEDGE	1176	902.23
06302500120000	TRAN VU DUY/KENT WAI/TINA	4411 HEDGE	1483	1137.76
06302500130000	STEWART GEORGE/MICHAEL	4423 HEDGE	1344	1031.12
06302500160000	UPPAL RAJNISH K	9109 ROSE PARADE	1474	1079.26
06302500170000	RIZK LAUDY Y	9113 ROSE PARADE	1330	973.83
06302500180000	YEE CALVIN	9117 ROSE PARADE	953	697.79
06302500190000	KEPING CHEN/HAO H XU AB LIVING	9121 ROSE PARADE	1474	1079.26
06302500200000	MCALLASTER AMY R	9106 ROSE PARADE	1176	902.23
06302500210000	NGUYEN VAN T	4440 TRUMPETER	1330	973.83
06302500220000	MEHTA PREMAL H	4448 TRUMPETER	1474	1079.26
06302500230000	DONOVAN DAVID/ALYSON	4449 TRUMPETER	1165	853.01
06302500250000	JAMES H WHITE FAMILY TRUST	9114 ROSE PARADE	1330	973.83
06302500260000	CHON AIMEE E	9118 ROSE PARADE	1176	902.23
06302500270000	CHAMBERS SUSAN C	9122 ROSE PARADE	1176	902.23
06302500280000	COUNTY OF SACRAMENTO	JACKSON	0	0.00
06302500290000	COUNTY OF SACRAMENTO	HEDGE	0	0.00
06302500390000	DAO LONG QUOC/TRANG THANH THI	9125 ROSE PARADE	1474	1079.26
06302500400000	GARCIA MONICA	9129 ROSE PARADE	1330	973.83
06302500410000	LONG GERALD L/KATHY L	9133 ROSE PARADE	1474	1079.26
06302500420000	DENISENKO SERGEY/TATYANA	9137 ROSE PARADE	1330	973.83
06302500450000	SINGH HARMITH K	9145 ROSE PARADE	1330	973.83
06302500460000	DANG ANTHONY	9149 ROSE PARADE	1474	1079.26
06302500470000	KARAZHOVA MARIYA	9153 ROSE PARADE	1330	973.83
06302500480000	REINKE RICHARD/DIANE	9159 ROSE PARADE	1474	1079.26
06302500490000	RUSSELL AMANDA	9158 ROSE PARADE	1330	973.83
06302500500000	WEBB DAREN/MARIA	9152 ROSE PARADE	1165	853.01
06302500510000	DAILEY OMAR R	4509 SPELLBINDER	1330	973.83
06302500520000	CANTRELL MARIO ROSSANO	4513 SPELLBINDER	1474	1079.26
06302500530000	COOK 1999 REVOCABLE TRUST	4517 SPELLBINDER	1165	853.01
06302500540000	RUSSELL AMELIA I	4521 SPELLBINDER	1330	973.83
06302500550000	HOWARD DAN/JOSELYN R	4525 SPELLBINDER	1474	1079.26
06302500560000	BURDILA VALERIAN	4529 SPELLBINDER	1330	973.83
06302500570000	COUNTY OF SACRAMENTO	JACKSON	0	0.00
06302500580000	COUNTY OF SACRAMENTO	JACKSON	0	0.00
06302500590000	COUNTY OF SACRAMENTO	JACKSON	0	0.00
06302500610000	YEARWOOD ANTOINETTE M	9141 ROSE PARADE	1165	853.01
06302500620000	BEAZER HOMES HOLDINGS CORP	4346 HEDGE	1176	902.23
06302500630000	LOR PENNEY/JONATHAN M LEUNG	4342 HEDGE	1344	1031.12
06302500640000	LOPEZ EMILIO G JR	4338 HEDGE	1483	1137.76
06302500650000	TURNER JULIETTE	4334 HEDGE	960	736.51

SACRAMENTO CITY UNIFIED SCHOOL DISTRICT
Community Facilities District No. 2
2019-2020
Special Tax Roll

Assessor Parcel Number	Owner	Site Address	Square ft.	CFD #2 Tax
06302500660000	SILVER BEAR PROPERTIES LLC	4330 HEDGE	1344	1031.12
06302500670000	SAVINO/ANTOINETTE CAPOSSELE	4326 HEDGE	1176	902.23
06302500680000	CASTRO URSULA L	4322 HEDGE	1344	1031.12
06302500690000	ELLZEY THAD L JR/MALENA D	4318 HEDGE	960	736.51
06302500700000	PAPPAS DENEILIA R	4314 HEDGE	1344	1031.12
06302500710000	NATALI CAREN L/NATALI	4310 HEDGE	1176	902.23
06302500720000	KIM WAN SUEK/JUNG SUK	4306 HEDGE	1344	1031.12
06302500730000	LIN GUOJIAN/PU PENG	4302 HEDGE	1483	1137.76
06302500740000	IH6 PROP WEST LIMITED	4248 HEDGE	1176	902.23
06302500750000	DENTON RYAN	4244 HEDGE	1344	1031.12
06302500760000	KRASNYANSKAYA	4240 HEDGE	1176	902.23
06302500770000	DDUNGU EDRINE/JULIET R	9215 ROSE PARADE	1483	1137.76
06302500780000	NGUYEN TAN/ANH NGUYET BUI	9221 ROSE PARADE	1483	1137.76
06302500790000	SHU FAMILY TRUST	9220 ROSE PARADE	1344	1031.12
06302500800000	RUEHLIG JOSHUA P	9216 ROSE PARADE	1176	902.23
06302500810000	BRENNAN JONATHAN/MIREYA	9212 ROSE PARADE	1483	1137.76
06302500820000	DALTON REGINA	9208 ROSE PARADE	1344	1031.12
06302500830000	SAECHAO FEY V	9204 ROSE PARADE	1344	1031.12
06302500840000	CHOI KYONG CHUL	9200 ROSE PARADE	1483	1137.76
06302500850000	MIKULECKY FAMILY TRUST	9196 ROSE PARADE	1344	1031.12
06302500860000	TRAN DAT T/THUYTIEN D	9192 ROSE PARADE	1176	902.23
06302500870000	CHRISTOPHERSON TAMI C/JAY	9188 ROSE PARADE	1483	1137.76
06302500880000	YOUNGMAN FAMILY TRUST	9180 ROSE PARADE	1176	902.23
06302500890000	GURBACHAN SINGH REVOCABLE	9176 ROSE PARADE	1344	1031.12
06302500900000	CHON MIN H	4509 OLYMPIAD	1483	1137.76
06302500910000	GARZA PAMELA	4513 OLYMPIAD	1344	1031.12
06302500920000	CHAUDHARY AMRINDER/RAVINDER	4517 OLYMPIAD	1483	1137.76
06302500930000	CHECHOTKA VLADIMIR/LARISA	4521 OLYMPIAD	1344	1031.12
06302500940000	KOKUA TRUST	4525 OLYMPIAD	1176	902.23
06302500950000	TAH 2016 1 BORROWER LLC	4529 OLYMPIAD	1483	1137.76
06302500960000	CISCOE CHELSEA M	4533 OLYMPIAD	1344	1031.12
06302500970000	QUACH LIEU FAMILY TRUST	4537 OLYMPIAD	1483	1137.76
06302500980000	THOMPSON KEAVAN	4532 OLYMPIAD	1344	1031.12
06302500990000	LONG GERALD	4528 OLYMPIAD	1483	1137.76
06302501000000	HACKETT SEAN	4524 OLYMPIAD	1176	902.23
06302501010000	PARK YONG	4520 OLYMPIAD	1483	1137.76
06302501020000	MARTINEZ MARIO	4516 OLYMPIAD	1176	902.23
06302501030000	BUZICHEVICI CAZIMIR/TAMARA	4512 OLYMPIAD	1483	1137.76
06302501040000	REMSON NATALIE	4508 OLYMPIAD	1344	1031.12
06302501050000	COOK REV SURVIVORS TRUST	9166 ROSE PARADE	1483	1137.76
06302501060000	DO HUONG D/HANG D	9162 ROSE PARADE	1176	902.23
06302501070000	KAUR PARMJIT/HARJEET SINGH	9163 ROSE PARADE	1483	1137.76

SACRAMENTO CITY UNIFIED SCHOOL DISTRICT
Community Facilities District No. 2
2019-2020
Special Tax Roll

Assessor Parcel Number	Owner	Site Address	Square ft.	CFD #2 Tax
06302501080000	KAUR PARMJIT/HARJEET SINGH	9167 ROSE PARADE	1344	1031.12
06302501090000	PEREZ MARCO POLO/BENERISA	9171 ROSE PARADE	960	736.51
06302501100000	HUYNH DUNG	9175 ROSE PARADE	1344	1031.12
06302501110000	HENNING JANET	9179 ROSE PARADE	1165	869.32
06302501120000	MARIE I WALTER LIVING TRUST	9183 ROSE PARADE	1483	1137.76
06302501130000	NELSON ROBERT L/SHARON E	4233 HEDGE	1483	1137.76
06302501140000	VAN KEVIN HUYEN/LIEN HUYNH	4237 HEDGE	1344	1031.12
06302501150000	MORRIS MICHAEL A	4241 HEDGE	1176	902.23
06302501160000	VAN MINH/JAMIE LUU/VAN	4245 HEDGE	1483	1137.76
06302501170000	ROSENBLATT RAYMOND/BEVERLY M	4249 HEDGE	1176	902.23
06302501180000	BILLINGS TRUST	4303 HEDGE	1483	1137.76
06302501190000	SCIPIO REVOCABLE TRUST	4307 HEDGE	1176	902.23
06302501200000	BERBER MARINA	4311 HEDGE	1344	1031.12
06302501210000	SIMONSON STACY	4321 HEDGE	1176	902.23
06302501220000	HAMID ALAA	4325 HEDGE	1483	1137.76
06302501240000	CARVACHO LIVING TRUST	4333 HEDGE	1344	1031.12
06302501250000	CLAY CONNOR L/CLAY HEATHER M	4337 HEDGE	1176	902.23
06302501260000	DEREBENSKIY ROMAN	4341 HEDGE	1344	1031.12
06302501270000	SHELAGH M FERGUSON FAMILY	4345 HEDGE	960	736.51
06302501280000	CALIFORNIA-AMERICAN WATER	ROSE PARADE	0	0.00
06302501300000	VUCICA MIHO/PAULA	4329 HEDGE	1176	902.23
06302501310000	AVILA KRISTAL A	ROSE PARADE	0	0.00
06302501330000	CORDOVA RECREATION/PARK	ROSE PARADE	0	0.00
06302501340000	VENTURA JEAN/DAVID C	4445 TRUMPETER	1344	1031.12
06302500150000	GRITZMACHER DEREK J/JENNA D	4431 HEDGE	0	0.00
03504000110000	MAC CHI V/CIEN L D	11 HERITAGE PARK	2207	0.00
04100650100000	DUONG QUOC DAT	7020 CANYON TREE	2234	0.00
04100660270000	DU JOHN ZHENG/SAIFANG YANG	2838 YREKA	2234	0.00
04905800010000	WELDEKIDAN YONAS H	32 LOMA VERDE	1395	0.00
04905800210000	WILLIAMS JACKSON ERIC	3227 WATER MILL	1686	0.00
06302500140000	HIATT RICHARD FRANK/DOROTHY	4427 HEDGE	1483	0.00
05202100080000	ASADA DEBBIE/FRANK	2132 JOHN STILL	2333	1947.82
04100630250000	SAECHAO TAWN S	2714 57TH	1132	787.87
04802700070000	MARQUEZ MICHELLE	7749 ADDISON	1504	1195.68
04905900270000	MADDEN EDWARD C/LINDA F	7480 TISDALE	1033	951.19
05202100540000	USHA SINGH LIVING TRUST	7718 SWEETBRIER	1638	1304.50
04100650070000	SINGH MUKUD L	7001 CARNATION	1596	676.27
04100650080000	LUI JANSON CHUN YIN/MEI Y LI/KIT C	6905 CAL VALLEY	1824	800.64

TOTALS:

\$1813713.090

EXHIBIT A - SPECIAL TAX NOTICE

NOTICE OF SPECIAL TAX

COMMUNITY FACILITIES DISTRICT NO. 2
SACRAMENTO CITY UNIFIED SCHOOL DISTRICT
COUNTY OF SACRAMENTO, CALIFORNIA

TO: THE PROSPECTIVE PURCHASER OF THE REAL PROPERTY KNOWN AS:

Three horizontal lines for entering the name of the prospective purchaser.

This information is Valid Through June 30, 2020.

THIS IS A NOTIFICATION TO YOU PRIOR TO YOUR PURCHASING THIS PROPERTY. THE SELLER IS REQUIRED TO GIVE YOU THIS NOTICE AND TO OBTAIN A COPY SIGNED BY YOU TO INDICATE THAT YOU HAVE RECEIVED AND READ THIS NOTICE.

- (1) This property is subject to a special tax, which is in addition to the regular property taxes and any other charges and benefit assessments on the parcel. This special tax may not be imposed on all parcels within the city or county where the property is located. If you fail to pay this tax when due each year, the property may be foreclosed upon and sold. The tax is used to provide public facilities or services that are likely to particularly benefit the property. YOU SHOULD TAKE THIS TAX AND THE BENEFITS FROM THE PUBLIC FACILITIES AND SERVICES FOR WHICH IT PAYS INTO ACCOUNT IN DECIDING WHETHER TO BUY THIS PROPERTY.
(2) The maximum annual special tax which may be levied against this parcel to pay for public facilities is \$_____ during the 2019-20 tax year, payable at time of issuance of building permit. In the event that a building permit for residential construction on the property for an increase in the residential assessable space in excess of 500 square feet is issued, the maximum annual special tax will be increased by an amount equal to the net increase in residential area times the residential special tax rate in effect in the tax year that such building permit is issued. In addition, an annual special tax will be charged in fiscal year 2020-21 for building permits issued between July 1, 2019 and June 30, 2020 as follows: \$1.0644 per square foot of new single family residential area and \$0.6200 per square foot of new multi-family residential area. The annual special tax will be levied for 30 years and the annual tax levy will increase according to the tax collection schedule by an annual amount not to exceed approximately 13%.
(3) The authorized facilities which are being paid for by the special taxes, and by the money received from the sale of bonds which are being repaid by the special taxes, to the extent that financing is available, are:
1) The repair, rehabilitation, modification and expansion of existing elementary and secondary school facilities;
2) The acquisition of sites and the construction of elementary and secondary school facilities with related appurtenances and support structures;
3) The acquisition of sites and the construction of non-school facilities to support District operations; and
4) The acquisition of related equipment and furnishings; all necessary to meet student population demands.

These facilities may not yet have all been constructed or acquired and it is possible that some may never be constructed or acquired.

In addition, the special taxes may be used to pay for costs of the following services: None

YOU MAY OBTAIN A COPY OF THE RESOLUTION WHICH AUTHORIZED CREATION OF THE COMMUNITY FACILITIES DISTRICT WHICH SPECIFIED MORE PRECISELY HOW THE SPECIAL TAX IS APPORTIONED AND HOW THE PROCEEDS OF THE TAX WILL BE USED, FROM THE SACRAMENTO CITY UNIFIED SCHOOL DISTRICT BY CALLING 264-4080. THERE MAY BE A CHARGE FOR THIS DOCUMENT NOT TO EXCEED THE ESTIMATED REASONABLE COST OF PROVIDING THE DOCUMENT.

I (WE) ACKNOWLEDGE THAT I (WE) HAVE READ THIS NOTICE AND RECEIVED A COPY OF THIS NOTICE PRIOR TO ENTERING INTO A CONTRACT TO PURCHASE OR DEPOSIT RECEIPT WITH RESPECT TO THE ABOVE REFERENCED PROPERTY. I (WE) UNDERSTAND THAT I (WE) MAY TERMINATE THE CONTRACT TO PURCHASE OR DEPOSIT RECEIPT WITHIN THREE DAYS AFTER RECEIVING THIS NOTICE IN PERSON OR WITHIN FIVE DAYS AFTER IT WAS DEPOSITED IN THE MAIL BY GIVING WRITTEN NOTICE OF THAT TERMINATION TO THE OWNER, SUBDIVIDER, OR AGENT SELLING THE PROPERTY.

DATE _____

Three horizontal lines for signature and date.